



USER MANUAL – EN
IN 82050 Table Tennis Glue Joola

USE

JOOLA X-Glue Green Power

1. Spread the glue equally over the foam part of the cover and the racket, then spread the glue with the foam roller.

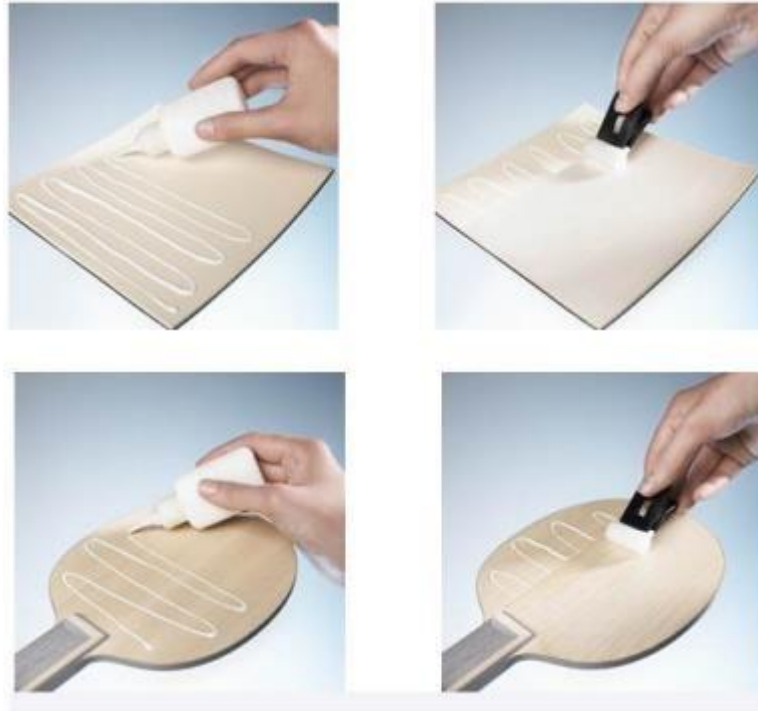

2. Wait for the glue to dry (it will be transparent, it takes about 4-5 minutes).
3. Fix the cover on the bat.

NOTE: Use the roller once.

JOOLA TUNING Rubbers

Pull the cover out of the packaging and glue it with JOOLA X-Glue Green power:

1. Apply the glue equally to the foam part of the cover and spread it with the foam roller.
2. Repeat on the racket.
3. Wait for the glue to dry (it will be transparent, it takes about 4-5 minutes). Fix the cover on the bat.

NOTE: Use the roller once.

Store the racket in **TUNING BOX**. Screw all screws and inflate the plastic bag to increase the pressure in the package.

NOTE: For longer effect of the glue use **JOOLA TUNING BOX**. These will increase the effect of the glue.

Faster glue application with JOOLA Rossi Turbo Tuning Glue

Preparation:

Spread equally glue **ROSSI TURBO** on foam part of the cover (dry time is about 2 hours, depending room temperature, humidity etc.)

When the glue dry (try by touching), apply second layer.

There are two ways to finishing applying the glue:

a) Faster method - with **JOOLA X-Glue Green Power**:

1. When the second layer dry on the cover, apply equally **JOOLA X-Glue Green Power** glue on the racket.
2. After 4-5 min (it will be transparent), fix the cover to the racket.

Glue will work for 7-10 days. According to the needs you can use this method any time.

b) Time consuming method – with more layers of **JOLLA ROSSI TURBO**:

1. Wait for the second layer of glue to dry **ROSSI TURBO**, dry time 8-10 hours.
2. Then apply third layer of **ROSSI TURBO** on the foam part of the cover with a brush. (dry time is about 2 hours, depending room temperature, humidity etc.)
3. Apply one layer of **ROSSI TURBO** glue on racket (dry time can be up to 10 hours, therefore apply thinner layer of **ROSSI TURBO** glue than on the cover.
4. After the glue on cover dry, apply fourth layer of **ROSSI TURBO** glue.
5. Once the glue is dry, attach the cover to the racket.

NOTE: This method use more layers of **ROSSI TURBO** glue, because one layer does not have sufficient adhesive effect.

With faster method, the glue will work for 7-10 days. If you prefer a faster method, you can repeat it at any time using methods a) or b).

NOTE: For longer effect of the glue use **JOOLA TUNING BOX**. These will increase the effect of the glue.

ENVIRONMENT PROTECTION

After the product lifespan expired or if the possible repairing is uneconomic, dispose it according to the local laws and environmentally friendly in the nearest scrapyard.

By proper disposal you will protect the environment and natural sources. Moreover, you can help protect human health. If you are not sure in correct disposing, ask local authorities to avoid law violation or sanctions.

TERMS AND CONDITIONS OF WARRANTY, WARRANTY CLAIMS

General Conditions of Warranty and Definition of Terms

All Warranty Conditions stated hereunder determine Warranty Coverage and Warranty Claim Procedure. Conditions of Warranty and Warranty Claims are governed by Act No. 89/2012 Coll. Civil Code, and Act No. 634/1992 Coll., Consumer Protection, as amended, also in cases that are not specified by these Warranty rules.

The seller is SEVEN SPORT s.r.o. with its registered office in Borivojova Street 35/878, Prague 13000, Company Registration Number: 26847264, registered in the Trade Register at Regional Court in Prague, Section C, Insert No. 116888.

According to valid legal regulations it depends whether the Buyer is the End Customer or not.

“The Buyer who is the End Customer” or simply the “End Customer” is the legal entity that does not conclude and execute the Contract in order to run or promote his own trade or business activities.

“The Buyer who is not the End Customer” is a Businessman that buys Goods or uses services for the purpose of using the Goods or services for his own business activities. The Buyer conforms to the General Purchase Agreement and business conditions.

These Conditions of Warranty and Warranty Claims are an integral part of every Purchase Agreement made between the Seller and the Buyer. All Warranty Conditions are valid and binding, unless otherwise specified in the Purchase Agreement, in the Amendment to this Contract or in another written agreement.

Warranty Conditions

Warranty Period

The Seller provides the Buyer a 24 months Warranty for Goods Quality, unless otherwise specified in the Certificate of Warranty, Invoice, Bill of Delivery or other documents related to the Goods. The legal warranty period provided to the Consumer is not affected.

By the Warranty for Goods Quality, the Seller guarantees that the delivered Goods shall be, for a certain period of time, suitable for regular or contracted use, and that the Goods shall maintain its regular or contracted features.

The Warranty does not cover defects resulting from (if applicable):

- User's fault, i.e. product damage caused by unqualified repair work, improper assembly, insufficient insertion of seat post into frame, insufficient tightening of pedals and cranks
- Improper maintenance
- Mechanical damages
- Regular use (e.g. wearing out of rubber and plastic parts, moving mechanisms, joints etc.)
- Unavoidable event, natural disaster
- Adjustments made by unqualified person
- Improper maintenance, improper placement, damages caused by low or high temperature, water, inappropriate pressure, shocks, intentional changes in design or construction etc.

Warranty Claim Procedure

The Buyer is obliged to check the Goods delivered by the Seller immediately after taking the responsibility for the Goods and its damages, i.e. immediately after its delivery. The Buyer must check the Goods so that he discovers all the defects that can be discovered by such check.

When making a Warranty Claim the Buyer is obliged, on request of the Seller, to prove the purchase and validity of the claim by the Invoice or Bill of Delivery that includes the product's serial number, or eventually by the documents without the serial number. If the Buyer does not prove the validity of the Warranty Claim by these documents, the Seller has the right to reject the Warranty Claim.

If the Buyer gives notice of a defect that is not covered by the Warranty (e.g. in the case that the Warranty Conditions were not fulfilled or in the case of reporting the defect by mistake etc.), the Seller

is eligible to require a compensation for all the costs arising from the repair. The cost shall be calculated according to the valid price list of services and transport costs.

If the Seller finds out (by testing) that the product is not damaged, the Warranty Claim is not accepted. The Seller reserves the right to claim a compensation for costs arising from the false Warranty Claim.

In case the Buyer makes a claim about the Goods that is legally covered by the Warranty provided by the Seller, the Seller shall fix the reported defects by means of repair or by the exchange of the damaged part or product for a new one. Based on the agreement of the Buyer, the Seller has the right to exchange the defected Goods for a fully compatible Goods of the same or better technical characteristics. The Seller is entitled to choose the form of the Warranty Claim Procedures described in this paragraph.

The Seller shall settle the Warranty Claim within 30 days after the delivery of the defective Goods, unless a longer period has been agreed upon. The day when the repaired or exchanged Goods is handed over to the Buyer is considered to be the day of the Warranty Claim settlement. When the Seller is not able to settle the Warranty Claim within the agreed period due to the specific nature of the Goods defect, he and the Buyer shall make an agreement about an alternative solution. In case such agreement is not made, the Seller is obliged to provide the Buyer with a financial compensation in the form of a refund.



SEVEN SPORT s.r.o.

Registered Office:	Borivojova 35/878, 130 00 Praha 3, Czech Republic
Headquarters:	Delnicka 957, 749 01 Vitkov, Czech Republic
Warranty & Service Centre:	Cermenska 486, 749 01 Vitkov, Czech Republic
CRN:	26847264
VAT ID:	CZ26847264
Phone:	+420 556 300 970
E-mail:	eshop@insportline.cz reklamace@insportline.cz servis@insportline.cz
Web:	www.insportline.cz

SK

INSPORTLIN s.r.o.

Headquarters, Warranty & Service centre:	Elektricka 6471, 911 01 Trencin, Slovakia
CRN: 36311723	
VAT ID: SK2020177082	
Phone:	+421(0)326 526 701
E-mail:	objednavky@insportline.sk reklamacie@insportline.sk servis@insportline.sk
Web:	www.insportline.sk

Date of Sale:

Stamp and Signature of Seller: