



## USER MANUAL – EN

### IN 30445 Electric four-wheel wheelchair inSPORTline Lubica II



# CONTENTS

- SAFETY INSTRUCTIONS..... 3
- SPECIFICATIONS..... 4
- CONTROLS..... 4
- DISPLAY DESCRIPTION..... 5
- IGNITION AND CONTROLLER ..... 5
- TRUNK ..... 6
- CLEANING AND MAINTENANCE ..... 6
- BEFORE USE..... 6
- BATTERY ..... 6
- BATTERY CHARGING..... 7
- TROUBLESHOOTING ..... 9
- ENVIRONMENT PROTECTION ..... 9
- TERMS AND CONDITIONS OF WARRANTY, WARRANTY CLAIMS..... 9

## **SAFETY INSTRUCTIONS**

- Please read the manual before use and keep it for future reference.
- Familiarize yourself with local regulations and laws before driving. Age limit and usage may vary from state to state. It is the user's responsibility to familiarize themselves with the laws first. Suitable for people aged 18 and older.
- Do not modify or repair the product.
- Do not use the scooter if sharp edges appear on the scooter.
- Never drive under the influence of alcohol, pills, or drugs.
- Before driving, check that the brakes and lights work properly.
- Check tire pressure regularly.
- Any new user must be familiarized with driving and using of the scooter.
- Never modify the structure or engine to increase performance, any modification will void the warranty.
- Before driving, adjust your mirrors so that you can see behind you.
- Always give your full attention to driving.
- Do not use a mobile phone or headphones while driving.
- Check the battery power before driving.
- Brake efficiency is reduced on wet surfaces, always brake slowly and with enough time to stop.
- Sudden braking may result in loss of balance and fall.
- Before driving, adjust the seat to a comfortable position so that you can comfortably control the scooter.
- Drive smoothly, avoid sudden changes in speed.
- Do not park the scooter unprotected in the rain or on direct sunlight.
- Do not stop on a steep hill.
- Drive only on paved terrain.
- Do not charge the scooter unattended.
- Protect against rain and water.
- Never leave the scooter running or with the key in the ignition unattended.
- Keep out of reach of children, if there are children around, prevent unauthorized use.
- If you want to use the scooter in normal road traffic, consult local regulations and laws about its suitability.
- Persons with reduced mobility must always be accompanied by another person.
- Consult your doctor about your ability to drive.
- If the scooter suddenly accelerates or decelerates, or any other abnormality occurs, stop driving immediately.
- The scooter is only intended for one person at a time.
- In reduced visibility, wear a reflective vest or clothing with reflective elements.
- Use only the original charger to charge the battery.
- Do not use the charger if it is damaged.

## SPECIFICATIONS

Dimensions (L*W*H)	1640*670*990 mm
Weight	85 kg
Max. speed	25 km/h
Max. range	40-50 km
Engine	1000W brushless
Brake	Front: disc, rear: drum
Ground height	85 mm
Battery	60V20Ah lead acid battery
Max. incline	≤15°

Maximum range and speed depend on terrain, user weight and other environmental conditions.

## CONTROLS

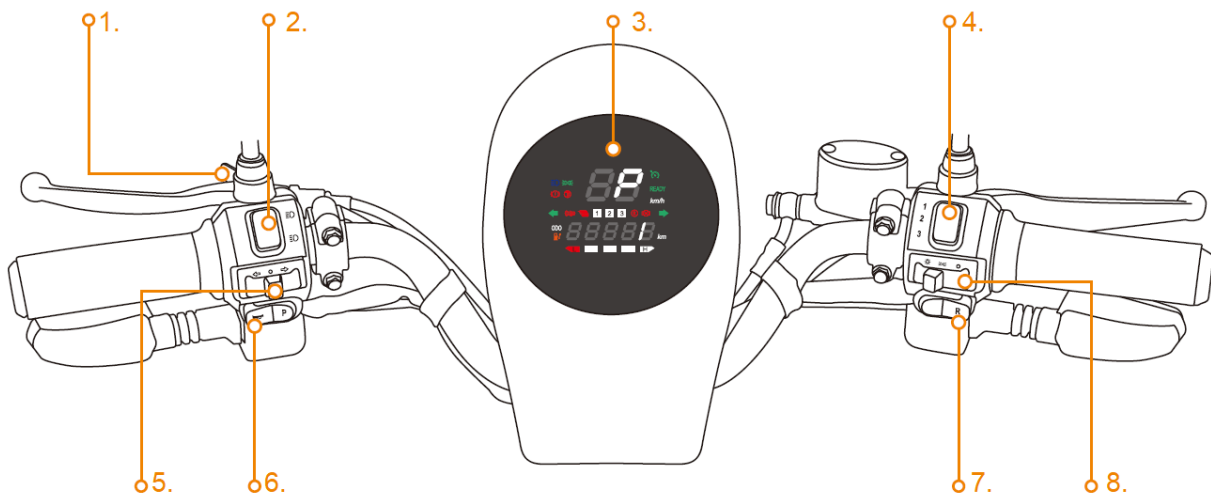

1. Handbrake	5. Turn signals
2. High/Low beam	6. Horn
3. LCD Display	7. Reverse button
4. Gear	8. Light switch

## DISPLAY DESCRIPTION

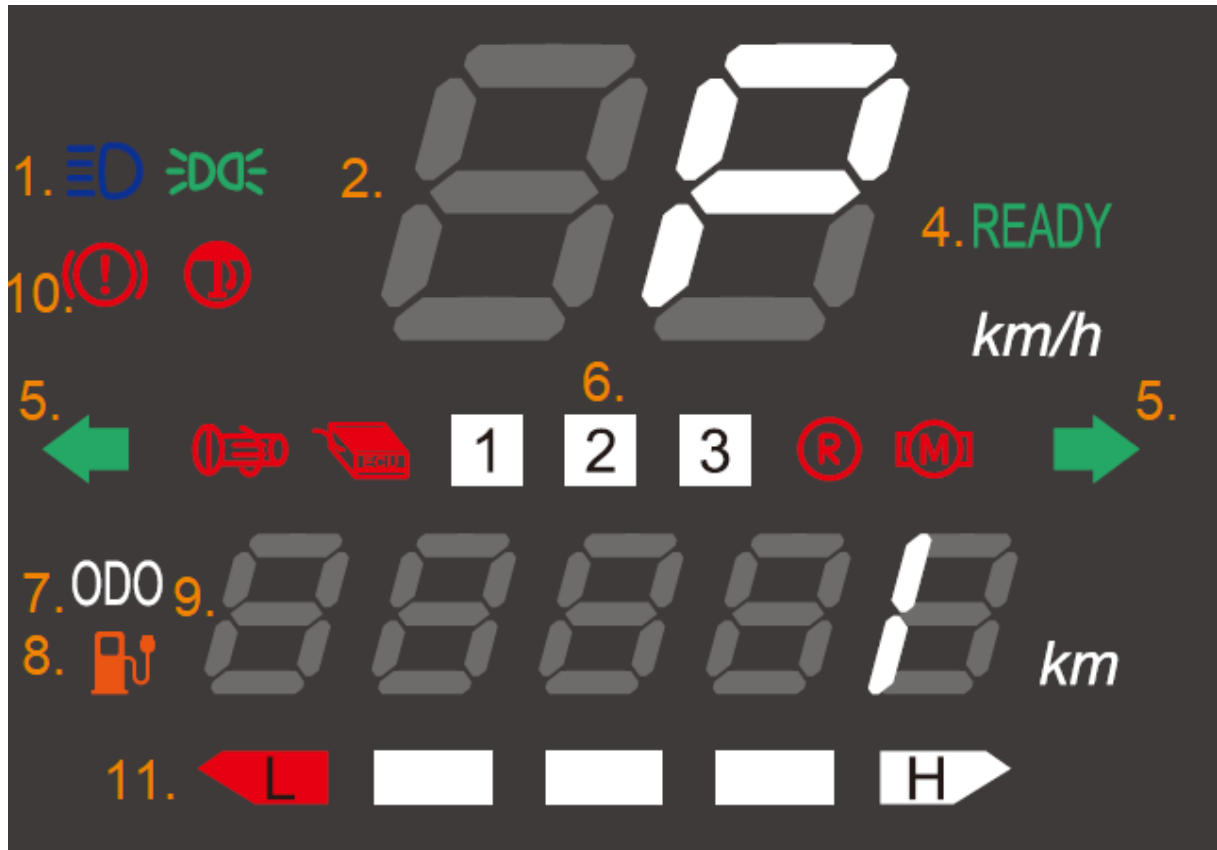

1. High/low beam	7. Total distance traveled
2. Current speed	8. Battery indicator
	9. Distance traveled
4. Ready to drive	10. Fault/error icons
5. Turn signals	11. Battery status
6. Gear	

## IGNITION AND CONTROLLER

### Start

Turn right to start (ON).

### Shutdown

Turn left to turn off (OFF).

### Handlebar lock

Turn left to lock the handlebars (LOCK).

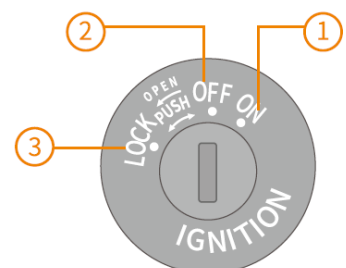

### Alarm activation

Press to activate the alarm.

### Alarm deactivation

Press to deactivate the alarm.

### Locator (sound signal)

Press to activate the sound signal to locate the wheelchair.

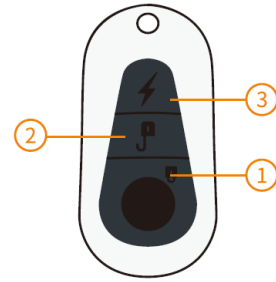

## TRUNK

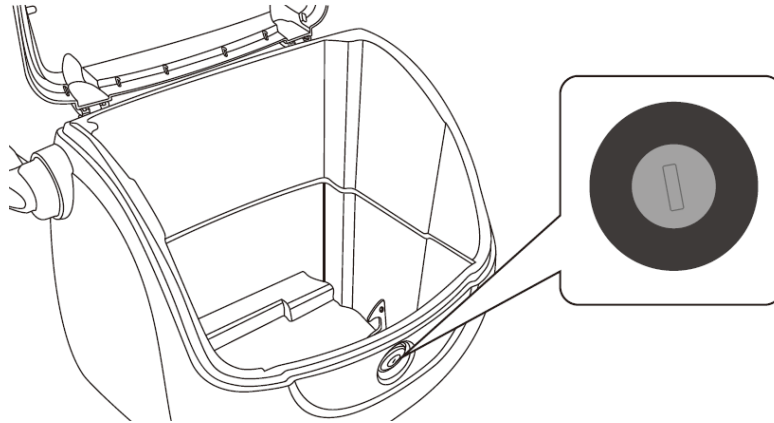

Insert the key into the lock and turn to the left to open the trunk.

## CLEANING AND MAINTENANCE

- Protect against water and excessive moisture to avoid damaging the internal electrical circuit.
- Do not use aggressive cleaning agents.
- Do not expose to extreme temperature conditions.
- Protect against sharp objects and edges.
- Protect against impacts.
- Do not repair the product yourself. Always contact the service department.

## BEFORE USE

Before driving, check the following:

- Functionality of brakes, lights, movement and clearance of the handlebars, etc.
- Check the correct tire pressure and condition.
- Adjust the seat to the correct position.
- Check the battery charge status.

## BATTERY

Batteries with gel electrolyte are maintenance-free and are generally considered more stable, safer and less risky than Li-ion batteries, which ensure safe operation even during long-term use. The batteries are highly efficient and have low self-discharge. We recommend recharging the battery regularly, even if it is not in use, about once a month, and storing it charged to 60-80% of its capacity.

Otherwise, the battery may be damaged, which can cause a shorter range or, in worse cases, complete inoperability. Regular recharging extends the battery lifespan. We recommend fully charging the battery before first use.

Warning! Never leave the battery discharged! Always recharge the battery until the charging indicator is not displaying full battery.

For proper functionality and safe use of the battery, follow the instructions in the manual. If the battery is damaged, liquid is leaking from it or there is an abnormal odor, stop using the battery immediately.

- The battery lifespan is limited. If you use a battery that exceeds its normal life, the charging frequency may increase, and the range may be reduced.
- Do not open the battery or throw it into a fire. Do not insert foreign objects into the battery.
- The ideal temperature for charging the battery is +10 °C to +30 °C.
- If you use the battery in a cold environment, its range will be reduced.
- Do not repair or modify the battery yourself.

## **BATTERY CHARGING**

The intelligent charger that is provided automatically disconnects the charger when the battery is 100% charged - it has overcharge protection.

Never cover the charger while charging, otherwise it may be damaged.

The charger may be damaged due to exposure to water, impacts, etc. In this case, the warranty period does not apply. Always charge the battery only when it is not used.

Never charge the battery with a charger other than the one that comes with the battery. Otherwise, there is a serious risk of damaging or destroying the battery.

Charging procedure

1. Remove the protective cap of the charging connector (socket) and insert the charger connector (plug) into it.
2. Connect the charger to the mains (230 V).
3. The charging process is functional if the LED light on the charger lights up red. When the battery is charged, the LED light will turn green.
4. After charging the battery, disconnect the charger from the mains and the charger connector (plug) from the connector (socket).
5. Carefully close the charging connector on the device with the protective cap.

Charger must be connected to a power supply AC220V±20% otherwise the battery can be undercharged. First connect the battery to scooter and after that to socket.

1. Open the charging port

2. Connect to power supply

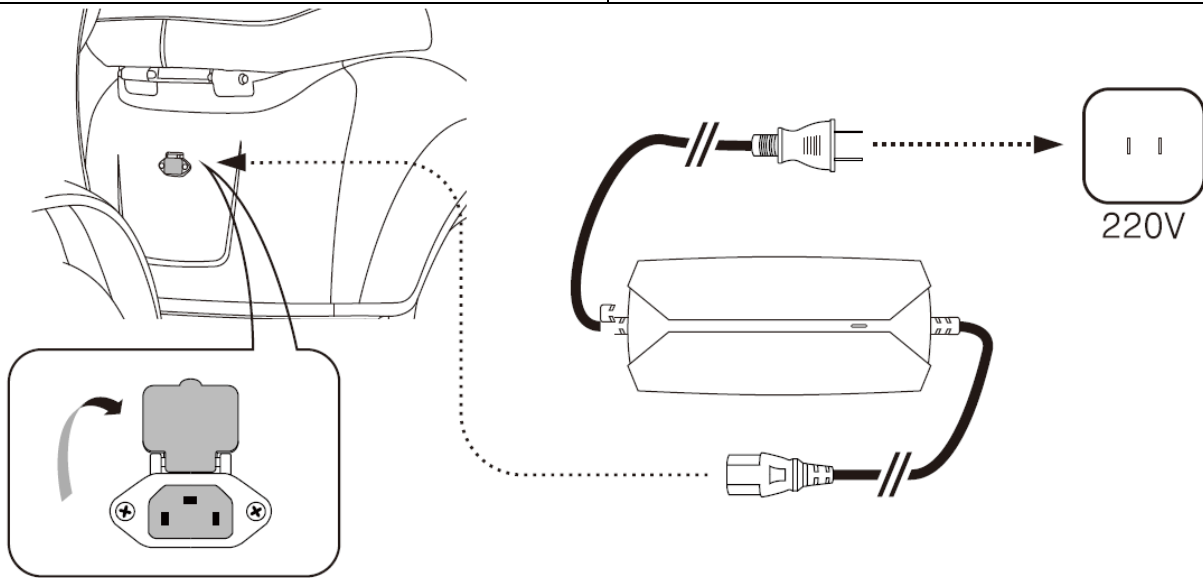

When the indicator is: Red – battery is charging.  
Orange – battery capacity is at 90%  
Green – battery capacity is full

During charging do not cover the charger

Protect the charger against impacts and falls.

Keep the charger away from water and heat sources.

Always charge the device under supervision.

If there is smell or the battery or the charger are hot or the charging time is long, stop charging the scooter and contact your supplier.

## TROUBLESHOOTING

Fault	Possible solution / cause
Display does not light up after powering up	<ol style="list-style-type: none"> <li>1. Check the key position</li> <li>2. Check that the power plug is connected</li> <li>3. Check electrical switch</li> </ol>
Motor is not working after powering up	<ol style="list-style-type: none"> <li>1. Check that the power cable on right side is connected</li> <li>2. Initial speed is low</li> <li>3. Check that left and right switch bars are powered off</li> </ol>
Slow speed	<ol style="list-style-type: none"> <li>1. Check brake</li> <li>2. Check tire pressure</li> <li>3. Check battery capacity</li> <li>4. Driving on incline or against strong headwind</li> </ol>
Short driving distance	<ol style="list-style-type: none"> <li>1. Check battery</li> <li>2. Check tire pressure</li> <li>3. Check brakes</li> <li>4. Check battery capacity</li> <li>5. Driving on incline or against strong headwind</li> <li>6. Low temperature</li> </ol>
Battery is not charged	<ol style="list-style-type: none"> <li>1. Check the charger and power supply</li> <li>2. Check voltage</li> </ol>

## ENVIRONMENT PROTECTION

After the product lifespan expired or if the possible repairing is uneconomic, dispose it according to the local laws and environmentally friendly in the nearest scrapyard.

By proper disposal you will protect the environment and natural sources. Moreover, you can help protect human health. If you are not sure in correct disposing, ask local authorities to avoid law violation or sanctions.

Don't put the batteries among house waste but hand them in to the recycling place.



## TERMS AND CONDITIONS OF WARRANTY, WARRANTY CLAIMS

### General Conditions of Warranty and Definition of Terms

All Warranty Conditions stated here under determine Warranty Coverage and Warranty Claim Procedure. Conditions of Warranty and Warranty Claims are governed by Act No. 89/2012 Coll. Civil Code, and Act No. 634/1992 Coll., Consumer Protection, as amended, also in cases that are not specified by these Warranty rules.

The seller is SEVEN SPORT s.r.o. with its registered office in Kutnohorská 531, Štěrboholy Retail Park, 109 00, Praha 10, ČR, Company Registration Number: 26847264, registered in the Trade Register at Regional Court in Prague, Section C, Insert No. 116888.

According to valid legal regulations it depends whether the Buyer is the End Customer or not.

“The Buyer who is the End Customer” or simply the “End Customer” is the legal entity that does not conclude and execute the Contract in order to run or promote his own trade or business activities.

“The Buyer who is not the End Customer” is a Businessman that buys Goods or uses services for the purpose of using the Goods or services for his own business activities. The Buyer conforms to the General Purchase Agreement and business conditions.

These Conditions of Warranty and Warranty Claims are an integral part of every Purchase Agreement made between the Seller and the Buyer. All Warranty Conditions are valid and binding, unless otherwise specified in the Purchase Agreement, in the Amendment to this Contract or in another written agreement.

### **Warranty Conditions**

#### **Warranty Period**

The Seller provides the Buyer a 24 months Warranty for Goods Quality, unless otherwise specified in the Certificate of Warranty, Invoice, Bill of Delivery or other documents related to the Goods. The legal warranty period provided to the Consumer is not affected.

By the Warranty for Goods Quality, the Seller guarantees that the delivered Goods shall be, for a certain period of time, suitable for regular or contracted use, and that the Goods shall maintain its regular or contracted features.

#### **Batteries**

6-month battery warranty – we guarantee that battery's nominal capacity does not fall below 70% of its total capacity within 6 months of the product's sale.

#### **The Warranty does not cover defects resulting from (if applicable):**

- User's fault, i.e. product damage caused by unqualified repair work, improper assembly, insufficient insertion of seat post into frame, insufficient tightening of pedals and cranks
- Improper maintenance
- Mechanical damages
- Regular use (e.g. wearing out of rubber and plastic parts, moving mechanisms, joints, wear of brake pads/blocks, chain, tires, cassette/multi wheel etc.)
- Unavoidable event, natural disaster
- Adjustments made by unqualified person
- Improper maintenance, improper placement, damages caused by low or high temperature, water, inappropriate pressure, shocks, intentional changes in design or construction etc.

### **Warranty Claim Procedure**

The Buyer is obliged to check the Goods delivered by the Seller immediately after taking the responsibility for the Goods and its damages, i.e. immediately after its delivery. The Buyer must check the Goods so that he discovers all the defects that can be discovered by such check.

When making a Warranty Claim the Buyer is obliged, on request of the Seller, to prove the purchase and validity of the claim by the Invoice or Bill of Delivery that includes the product's serial number, or eventually by the documents without the serial number. If the Buyer does not prove the validity of the Warranty Claim by these documents, the Seller has the right to reject the Warranty Claim.

If the Buyer gives notice of a defect that is not covered by the Warranty (e.g. in the case that the Warranty Conditions were not fulfilled or in the case of reporting the defect by mistake etc.), the Seller is eligible to require a compensation for all the costs arising from the repair. The cost shall be calculated according to the valid price list of services and transport costs.

If the Seller finds out (by testing) that the product is not damaged, the Warranty Claim is not accepted. The Seller reserves the right to claim a compensation for costs arising from the false Warranty Claim.

In case the Buyer makes a claim about the Goods that is legally covered by the Warranty provided by the Seller, the Seller shall fix the reported defects by means of repair or by the exchange of the damaged part or product for a new one. Based on the agreement of the Buyer, the Seller has the right to exchange the defected Goods for a fully compatible Goods of the same or better technical characteristics. The Seller is entitled to choose the form of the Warranty Claim Procedures described in this paragraph.

The Seller shall settle the Warranty Claim within 30 days after the delivery of the defective Goods, unless a longer period has been agreed upon. The day when the repaired or exchanged Goods is handed over to the Buyer is considered to be the day of the Warranty Claim settlement. When the Seller is not able to settle the Warranty Claim within the agreed period due to the specific nature of the Goods defect, he and the Buyer shall make an agreement about an alternative solution. In case such agreement is not made, the Seller is obliged to provide the Buyer with a financial compensation in the form of a refund.

**CZ**  
**SEVEN SPORT s.r.o.**

Registered Office: Kutnohorská 531, Štěrboholy Retail Park,  
109 00, Praha 10, ČR

Headquarters: Dělnická 957, Vítkov, 749 01  
Warranty & Service: Čermenská 486, Vítkov 749 01

CRN: 26847264  
VAT ID: CZ26847264

Phone: +420 556 300 970  
E-mail: eshop@insportline.cz  
reklamace@insportline.cz  
servis@insportline.cz

Web: www.inSPORTline.cz

**SK**  
**Stores inSPORTline SK, s.r.o.**

Headquarters, warranty & service center: Električná 6471,  
Trenčín 911 01, SK

CRN: 46259317  
VAT ID: SK2023299729

Phone: +421(0) 917 700 098  
E-mail: objednavky@insportline.sk  
reklamacie@insportline.sk  
servis@insportline.sk

Web: www.inSPORTline.sk

**About shipping**

