



USER MANUAL – EN

IN 28941 Thermoregulation system inSPORTline for cold water immersion tubs and baths



CONTENTS

SAFETY INSTRUCTIONS..... 3

PACKAGE CONTENTS 3

TECHNICAL PARAMETERS 3

INSTALLATION 4

APP CONTROL..... 7

CLEANING AND MAINTENANCE 9

ENVIRONMENT PROTECTION 10

TERMS AND CONDITIONS OF WARRANTY, WARRANTY CLAIMS..... 10

SevenSport s.r.o. reserves the right to make any changes and improvements to its product without prior notice. Visit our website www.insportline.eu where you will find the latest version of the manual.

SAFETY INSTRUCTIONS

- Read the manual before use and keep it for future reference.
- Keep out of reach of children and animals.
- Keep away from fire, flames and water.
- Do not touch electrical parts with wet or damp hands.
- Do not leave plugged in unattended.
- When not in use, protect against misuse by unauthorized persons.
- Plug only into a properly grounded outlet.

PACKAGE CONTENTS



TECHNICAL PARAMETERS

Temperature measurement range:	-5°C ~ 99°C
Temperature measurement accuracy:	±1°C
Display accuracy:	0.1°C
Setting range:	0 - 55°C
Operating temperature:	-5 ~ 55°C
Storage temperature:	-25°C ~ 75°C
Rated voltage:	220V~240V, 5%, 50 Hz
Atmospheric pressure of use:	86-106 kPa
Altitude of use:	<2000 m

INSTALLATION

1. Place the main unit on a flat and solid surface.

Do not place on an elevated place.



2. Connecting hoses

Insert the gasket into the hose. Wrap Teflon tape around the adapter thread and screw it into the top tap.



Insert a seal into the other end of the hose and connect it to the water outlet (water out), wrap Teflon tape around the thread.



Insert the gasket into the hose. Wrap Teflon tape around the adapter thread and screw it into the bottom tap.



Insert a seal into the other end of the hose and connect it to the water inlet, wrap Teflon tape around the thread.



The top outlet of the main unit is connected to the top valve.

The bottom inlet of the main unit is connected to the bottom valve.

Make sure the valves are tightened properly.



3. Connect the condensation drain hose



Lay the main unit on its side and find the valve for the condensation hose on the bottom.

4. Valves



1. Make sure the valve is turned off until you have completed the installation of the entire device.

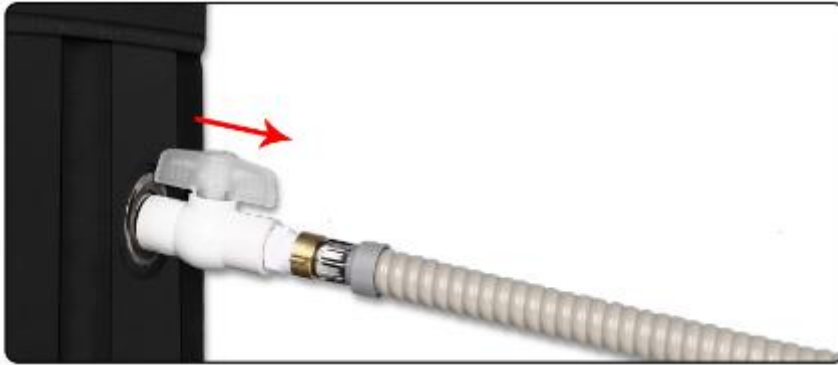



2. After the installation is complete and the tub is filled with water, you can turn off the tap.

5. Switch on



Fill the tub with sufficient water. Plug in the main unit.



Press the power button  to start the thermoregulation system. Press the water pump button  to start the water pump, the corresponding indicator will light up.

If the indicator is flashing, it means that the function is active and the device is preparing to set to the given temperature.

6. Controls



The display on the left shows the current temperature, the display on the right shows the set target temperature.

Use the up / down buttons   to set the desired temperature. The value is saved after 3 minutes of inactivity.

Use the  button to start ozone disinfection.

Cooling program: after about 5 minutes the fan starts to blow warm air

Heating program: after about 5 minutes the fan starts to blow cool air

APP CONTROL

1. Download the app

Scan the QR code or search for the “Graffiti intelligence” app on the Apple Store or Google play.



2. Create an account

Register and accept the terms of use after reading.

You can register using your email address or phone number. After entering your details, a verification code will be sent to your email or phone number. Enter the verification code and complete the registration.

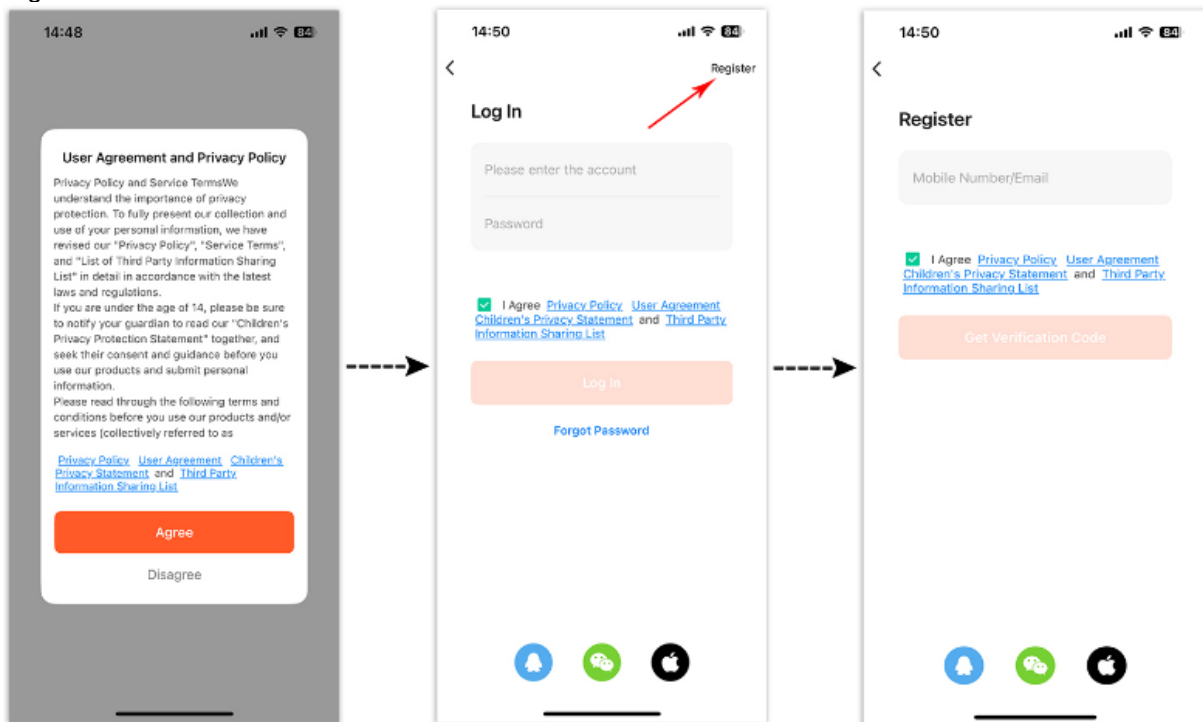

3. Add a device

Select “Add device” or press + in the upper right corner.

There are two ways to add a device: manual and automatic. To automatically search for devices, you must allow the application to use Bluetooth and WiFi.

For pairing, the thermoregulation system and the phone must be connected to the same WiFi network.

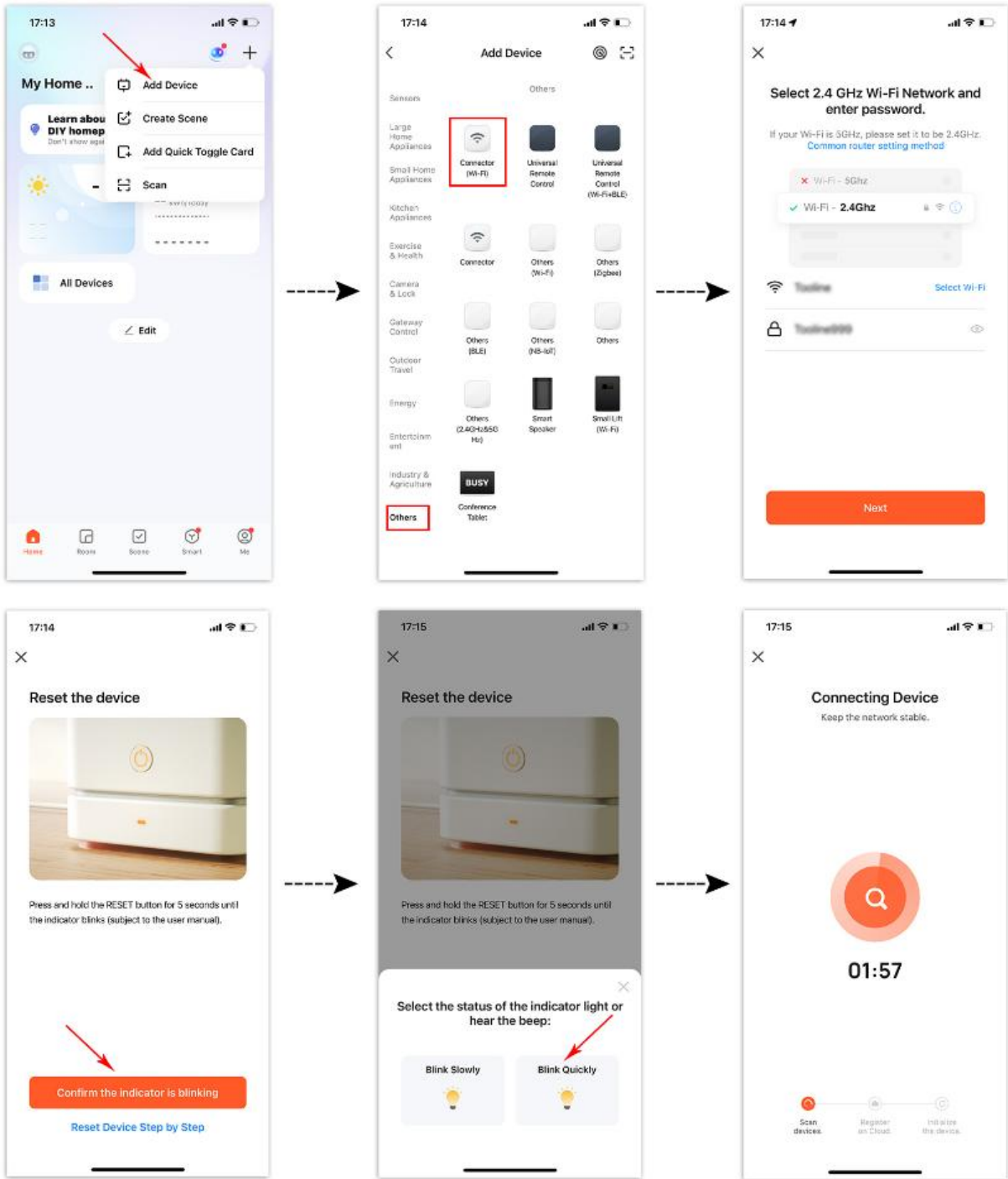

4. Application control

Once the device is paired, it will appear in the device list.

You can start/set the temperature/start ozone disinfection in the app.

If the temperature is not displayed correctly, press the settings icon and then temperature correction.

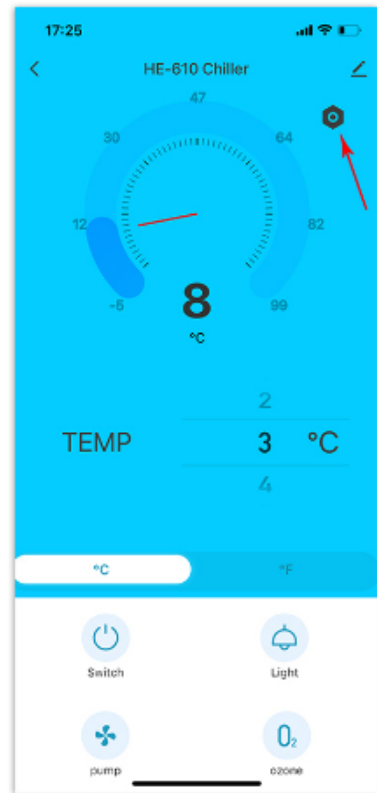
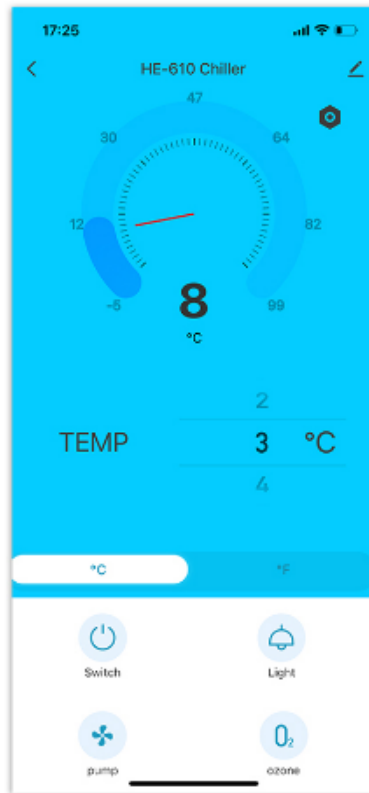
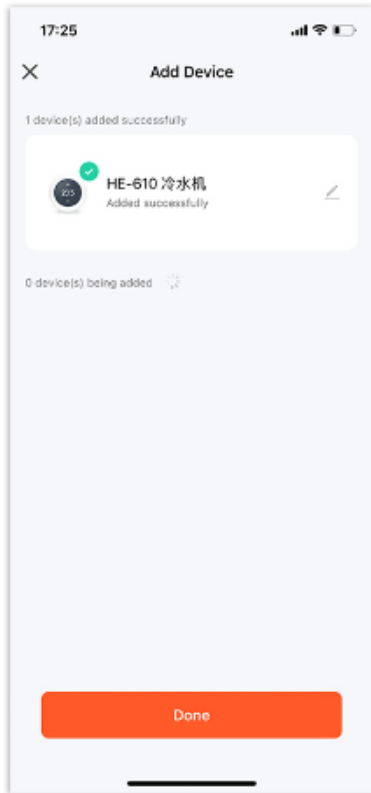

CLEANING AND MAINTENANCE

Daily

Clean the surface of the device with a damp cloth soaked in warm water and then dry with a cloth.

Filter Cleaning

Regularly check the filter for dirt. If the filter cannot be cleaned, it needs to be replaced.



Deep cleaning (once every 3-6 months)

Add neutral detergent to the filled tub and let the thermoregulation system run for 1 hour. Then turn off the system and drain the water. Then let the system run for 5 minutes. In case of heavy soiling, repeat the step above.

Storage

Before storing, the thermoregulation system must be allowed to dry. Place the system in a dry and well-ventilated place. Regularly check for dust or moisture.

ENVIRONMENT PROTECTION

After the product lifespan expires or if the possible repairing is uneconomical, dispose of it according to the local laws and is environmentally friendly in the nearest scrapyards.

By proper disposal you will protect the environment and natural resources. Moreover, you can help protect human health. If you are not sure of the correct disposing, ask local authorities to avoid law violations or sanctions.

Don't put the batteries among house waste but hand them in to the recycling place.

TERMS AND CONDITIONS OF WARRANTY, WARRANTY CLAIMS

General Conditions of Warranty and Definition of Terms

All Warranty Conditions stated here under determine Warranty Coverage and Warranty Claim Procedure. Conditions of Warranty and Warranty Claims are governed by Act No. 89/2012 Coll. Civil Code, and Act No. 634/1992 Coll., Consumer Protection, as amended, also in cases that are not specified by these Warranty rules.

The seller is SEVEN SPORT s.r.o. with its registered office in Strakonická street 1151/2c, Prague 150 00, Company Registration Number: 26847264, registered in the Trade Register at Regional Court in Prague, Section C, Insert No. 116888.

According to valid legal regulations it depends whether the Buyer is the End Customer or not.

"The Buyer who is the End Customer" or simply the "End Customer" is the legal entity that does not conclude and execute the Contract in order to run or promote his own trade or business activities.

"The Buyer who is not the End Customer" is a Businessman that buys Goods or uses services for the purpose of using the Goods or services for his own business activities. The Buyer conforms to the General Purchase Agreement and business conditions.

These Conditions of Warranty and Warranty Claims are an integral part of every Purchase Agreement made between the Seller and the Buyer. All Warranty Conditions are valid and binding, unless otherwise specified in the Purchase Agreement, in the Amendment to this Contract or in another written agreement.

Warranty Conditions

Warranty Period

The Seller provides the Buyer a 24 months Warranty for Goods Quality, unless otherwise specified in the Certificate of Warranty, Invoice, Bill of Delivery or other documents related to the Goods. The legal warranty period provided to the Consumer is not affected.

By the Warranty for Goods Quality, the Seller guarantees that the delivered Goods shall be, for a certain period of time, suitable for regular or contracted use, and that the Goods shall maintain its regular or contracted features.

Batteries

6-month battery warranty – we guarantee that battery's nominal capacity does not fall below 70% of its total capacity within 6 months of the product's sale.

The Warranty does not cover defects resulting from (if applicable):

- User's fault, i.e. product damage caused by unqualified repair work, improper assembly, insufficient insertion of seat post into frame, insufficient tightening of pedals and cranks
- Improper maintenance
- Mechanical damages
- Regular use (e.g. wearing out of rubber and plastic parts, moving mechanisms, joints, wear of brake pads/blocks, chain, tires, cassette/multi wheel etc.)
- Unavoidable event, natural disaster

- Adjustments made by unqualified person
- Improper maintenance, improper placement, damages caused by low or high temperature, water, inappropriate pressure, shocks, intentional changes in design or construction etc.

Warranty Claim Procedure

The Buyer is obliged to check the Goods delivered by the Seller immediately after taking the responsibility for the Goods and its damages, i.e. immediately after its delivery. The Buyer must check the Goods so that he discovers all the defects that can be discovered by such check.

When making a Warranty Claim the Buyer is obliged, on request of the Seller, to prove the purchase and validity of the claim by the Invoice or Bill of Delivery that includes the product's serial number, or eventually by the documents without the serial number. If the Buyer does not prove the validity of the Warranty Claim by these documents, the Seller has the right to reject the Warranty Claim.

If the Buyer gives notice of a defect that is not covered by the Warranty (e.g. in the case that the Warranty Conditions were not fulfilled or in the case of reporting the defect by mistake etc.), the Seller is eligible to require a compensation for all the costs arising from the repair. The cost shall be calculated according to the valid price list of services and transport costs.

If the Seller finds out (by testing) that the product is not damaged, the Warranty Claim is not accepted. The Seller reserves the right to claim a compensation for costs arising from the false Warranty Claim.

In case the Buyer makes a claim about the Goods that is legally covered by the Warranty provided by the Seller, the Seller shall fix the reported defects by means of repair or by the exchange of the damaged part or product for a new one. Based on the agreement of the Buyer, the Seller has the right to exchange the defected Goods for a fully compatible Goods of the same or better technical characteristics. The Seller is entitled to choose the form of the Warranty Claim Procedures described in this paragraph.

The Seller shall settle the Warranty Claim within 30 days after the delivery of the defective Goods, unless a longer period has been agreed upon. The day when the repaired or exchanged Goods is handed over to the Buyer is considered to be the day of the Warranty Claim settlement. When the Seller is not able to settle the Warranty Claim within the agreed period due to the specific nature of the Goods defect, he and the Buyer shall make an agreement about an alternative solution. In case such agreement is not made, the Seller is obliged to provide the Buyer with a financial compensation in the form of a refund.

CZ SEVEN SPORT s.r.o.

Registered Office: Strakonická 1151/2c, Praha 5, 150 00, ČR
Headquaters: Dělnická 957, Vítkov, 749 01
Warranty & Service: Čermenská 486, Vítkov 749 01

CRN: 26847264
VAT ID: CZ26847264
Phone: +420 556 300 970
E-mail: eshop@insportline.cz
reklamace@insportline.cz
servis@insportline.cz

Web: www.inSPORTline.cz

SK Stores inSPORTline SK, s.r.o.

Headquaters, warranty & service center: Električná 6471,
Trenčín 911 01, SK

CRN: 46259317
VAT ID: SK2023299729
Phone: +421(0) 917 700 098
E-mail: objednavky@insportline.sk
reklamacie@insportline.sk
servis@insportline.sk

Web: www.inSPORTline.sk

About shipping

