



**USER MANUAL – EN**

**IN 23641 Massage chair inSPORTline Cortela**



# CONTENTS

- SAFETY INSTRUCTIONS..... 3
- WARNING ..... 5
- PRODUCT DESCRIPTION ..... 6
- FUNCTION ..... 7
- CONTROLLER ..... 8
  - DISPLAY ..... 8
  - BUTTONS ..... 9
- USE ..... 10
  - CONNECTION..... 10
  - TURN ON..... 10
  - PAUSE ..... 12
  - MENU..... 12
  - AUTOMATIC MESSAGE ..... 13
  - SPECIAL AUTOMATIC MESSAGE..... 14
  - MANUAL MASSAGE ..... 15
  - SPEED, WIDTH AND INTENSITY ADJUSTMENT ..... 21
- SETTINGS..... 23
- BUTTONS..... 27
  - ADJUSTMENTS ..... 27
  - QUICK SELECTION BUTTON ..... 28
- SWITCH OFF THE CHAIR..... 28
- ASSEMBLY ..... 29
  - PILLOWS ..... 31
- FLOOR PROTECTION..... 31
- SPECIFICATIONS..... 32
- ENVIRONMENT PROTECTION ..... 33
- TERMS AND CONDITIONS OF WARRANTY, WARRANTY CLAIMS..... 33

# SAFETY INSTRUCTIONS

## IMPORTANT SAFETY WARNINGS

- Place the product on flat and solid surface and keep at least 0.6 m free space around the product.
- Kids can move around this product only under adult supervision.
- Use only well-grounded socket and proper power cord.
- Pull out the plug after every use or during maintenance to avoid injury or damaging the product.
- Please use this product according to the manual.
- Do not use unauthorized modifications or accessories.
- Only for indoor use.
- Before first use, please read the manual carefully.
- Use this product as is described in the manual.
- Recommended maximum use time is 20 minutes.
- Do not use the device if it is damaged. (frame, leather etc.)
- Do not use the chair if the ventilation is blocked.
- Do not put on chair heavy items or objects with sharp edge.
- Do not fall asleep during massage for safety reasons.
- Do not use the chair after you consumed alcohol or other drugs or if you are sick or dizzy.
- Do not use within one hour after meal.
- Please be caution and do not use too strong massage.
- **Maximum load:** 150 kg

## POSITION OF MASSAGE CHAIR

- Do not use the chair in high temperatures or moist environments (e.g. bathroom).
- Do not use the chair immediately after temperature change.
- Do not use in dust or impropriety rooms.
- It is important to secure enough space and ventilation.

## PEOPLE THAT SHOULD NOT USE THE PRODUCT

- People suffering from osteoporosis.
- People who has heart problems or are using electronic medical equipment (e.g. pacemaker).
- People suffering fever.
- Pregnant women.
- People suffering skin diseases.
- Kids younger 14 years old or people suffering mental illness can use this product only under adult supervision.
- People that are recommended rest from the doctor or people suffering from sickness.
- Do not use this chair if you have wet body.
- Do not use the heat function if you are heat sensitive.

## SAFETY

- Maintenance should be done only by a qualified person. Users should not disassemble the chair or do the maintenance by themselves.
- After every use unplug the cord.
- Do not use the product if the power cord, plug or socket are damaged.
- If you are not using the chair for a long period of time, store it in a clean and dry place and secure the power cord.
- Do not expose the chair to high temperatures, direct sunlight and do not place the chair near a heat source.
- If the power cord, plug or socket are damaged, ask a professional or qualified person for help.
- For cleaning use a wet sponge only. Do not use thinner, gasoline or alcohol for cleaning.
- Mechanical parts are assembled and made to require minimum maintenance.
- Pay extra attention to not damage the chair with sharp objects.
- Do not push the chair on uneven ground, always pick the chair up and then move.
- Do not let the chair work for long periods of time.

#### **COMMON PROBLEMS AND SOLUTIONS**

- It is common that the motor is making sounds.
- If the chair is not working please check the power cord, plug and socket and that the switch is ON.
- After the massage time is over the massage chair will turn OFF. The product will automatically shutdown if it is overheated – wait at least half an hour before next massage.

## WARNING

If the footrest rises, do not apply pressure to the footrest. You may damage the product or injure yourself.

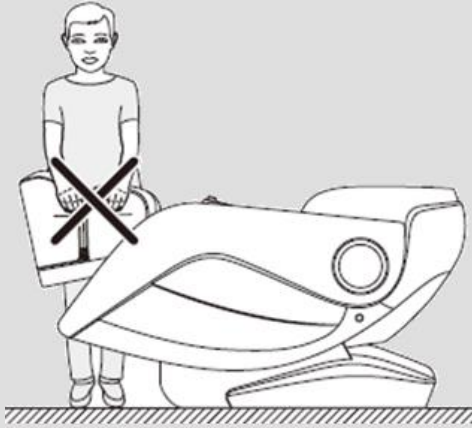

Before sitting down, make sure that the massage heads do not protrude from the seat. You may damage the heads or be injured.

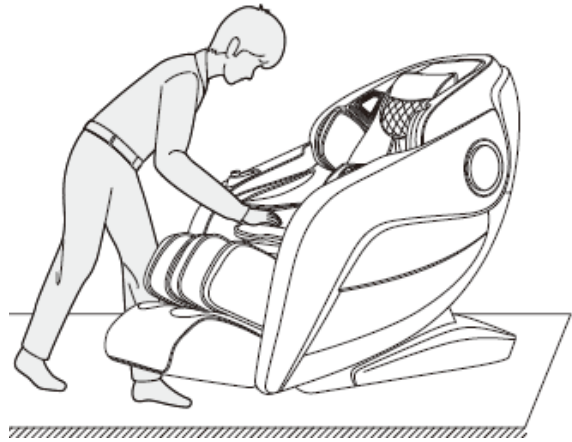

Never unplug the power cord during use or when the chair is in standby mode. After use, we recommend switching off the chair and unplugging the power cord.

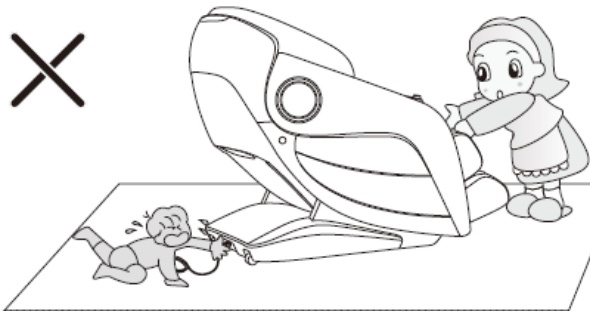

Before using the angle adjustment function, make sure that you have enough free space and that there are no other people or pets behind the chair.

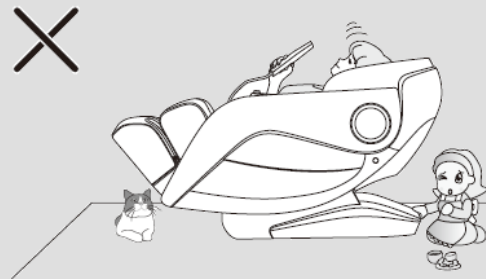

# PRODUCT DESCRIPTION

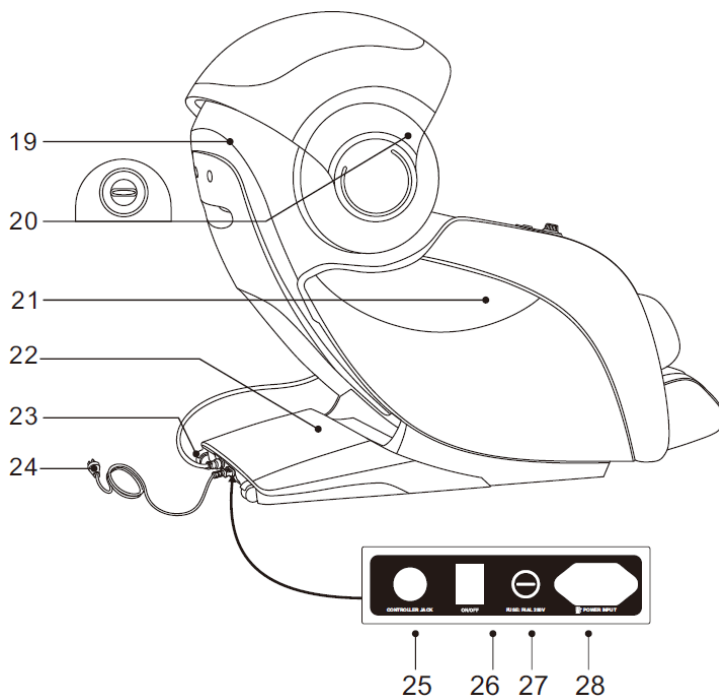
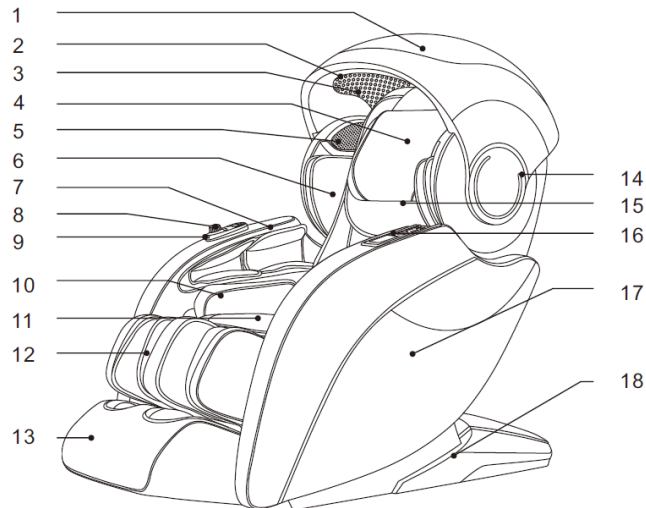

- 1. Canopy
- 2. LED blue light
- 3. Lights
- 4. Pillows
- 5. 3D speakers and aromatherapy
- 6. Upper arm airbags
- 7. Arm airbags
- 8. Quick use buttons
- 9. USB charging port
- 10. Buttock airbags
- 11. Seat
- 12. Leg rest
- 13. Footrest
- 14. LED lighting
- 15. Backrest
- 16. Controller
- 17. Armrests
- 18. Side cover
- 19. Back cover
- 20. Aperture for aromatic oils
- 21. Side decorative cover
- 22. Drive cover
- 23. Wheels
- 24. Power cord and plug
- 25. Controller connection
- 26. Switch
- 27. Fuses
- 28. Power socket

## FUNCTION

- The chair contains 3D massage heads that move up and down, forwards and backwards in quiet operation.
- It automatically detects the position of the shoulders and adjusts the position of the massage heads. It automatically detects the shape of the human body and adjusts the movement of the massage heads forwards and backwards.
- 6 types of massages: Shiatsu, buttocks, deep massage, neck and shoulders, back stretching, relaxation massage.
- 3 special massage functions: blue light therapy, healing, spa.
- 3 positions for storing your own massages.
- 5 positions of upper body massage: total massage, partial, fixed, upper and lower back, shoulders.
- 6 massage techniques: shoulder massage, kneading, tapping, Shiatsu, kneading and tapping, 3D massage; for all techniques it is possible to set 5 speeds, in Shiatsu and double tap modes you can set 5 positions of the width of the massage heads.
- Air cushion massage: upper arm (8 airbags), lower arm (4 airbags), back massage (4 airbags), foot massage (22 airbags), foot massage (12 airbags), buttocks massage (4 airbags). 3 intensity options.
- Heated back and legs, carbon fiber is used as a source of infrared light.
- The backrest frame uses track technology, so the backrest does not take up excess space when angled.
- Waist massage with air cushions.
- Quick control buttons on the right.
- Massage rollers for foot massage. The footrest automatically detects the distance and then adjusts the most comfortable angle.
- Ergonomic backrest.
- 8 magnets in the foot area.
- Adjustable LED lights on the right and left side.
- USB charging port on the right.
- Movable canopy for a relaxing massage using blue light.
- Aromatherapy.
- Driver with color TFT display.
- Possibility to connect a phone or tablet with a smart device via Bluetooth.
- 3D speakers.
- Double layer cushion for improved comfort.

# CONTROLLER

## DISPLAY

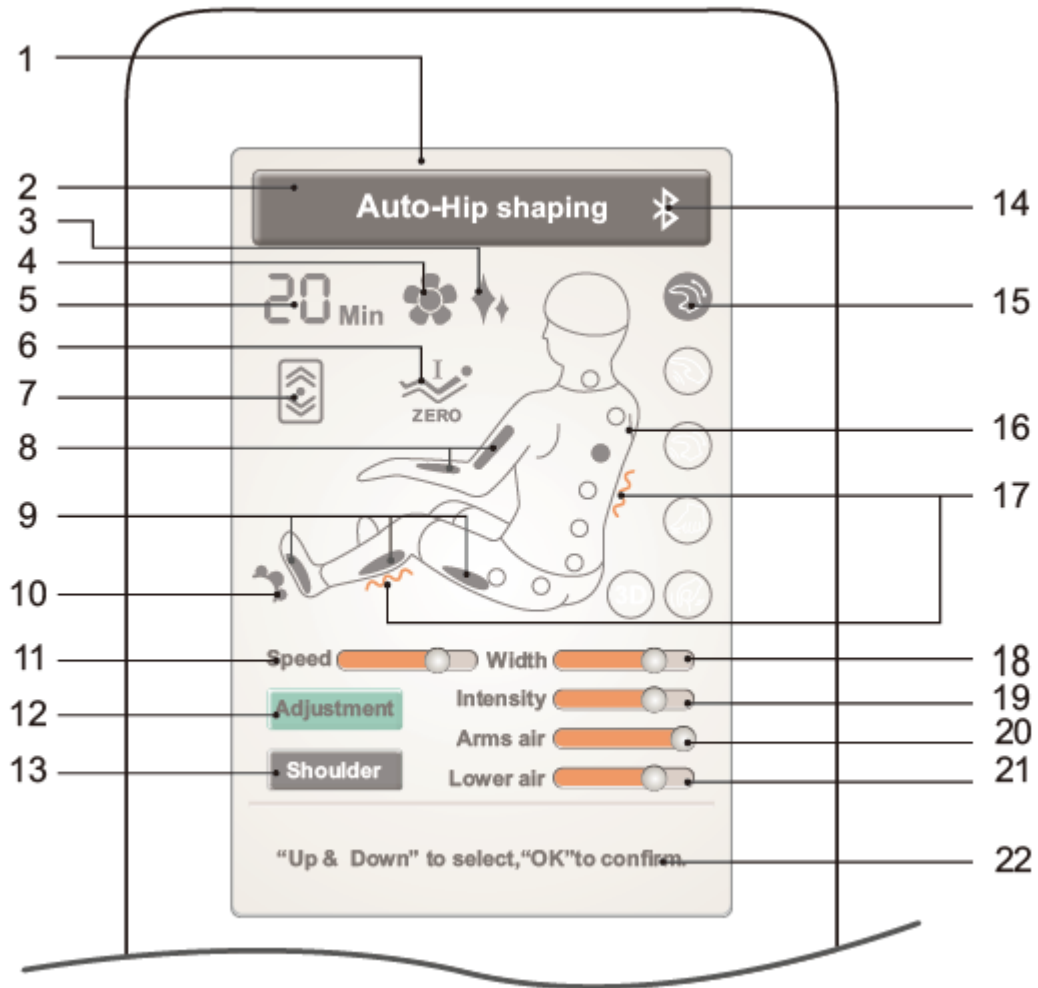

1. LCD display	12. Adjustment
2. Type of massage	13. Adjusting the position of the arms
3. Canopy	14. Bluetooth
4. Aromatherapy	15. Type of massage
5. Timer	16. Massage location
6. Zero gravity	17. Heating settings
7. Display of the type of back massage	18. Width adjustment
8. Arm massage using airbags	19. Massage intensity
9. Leg massage using airbags	20. Arm intensity adjustment
10. Massage rollers	21. Leg intensity adjustment
11. Speed setting	22. Information



# BUTTONS

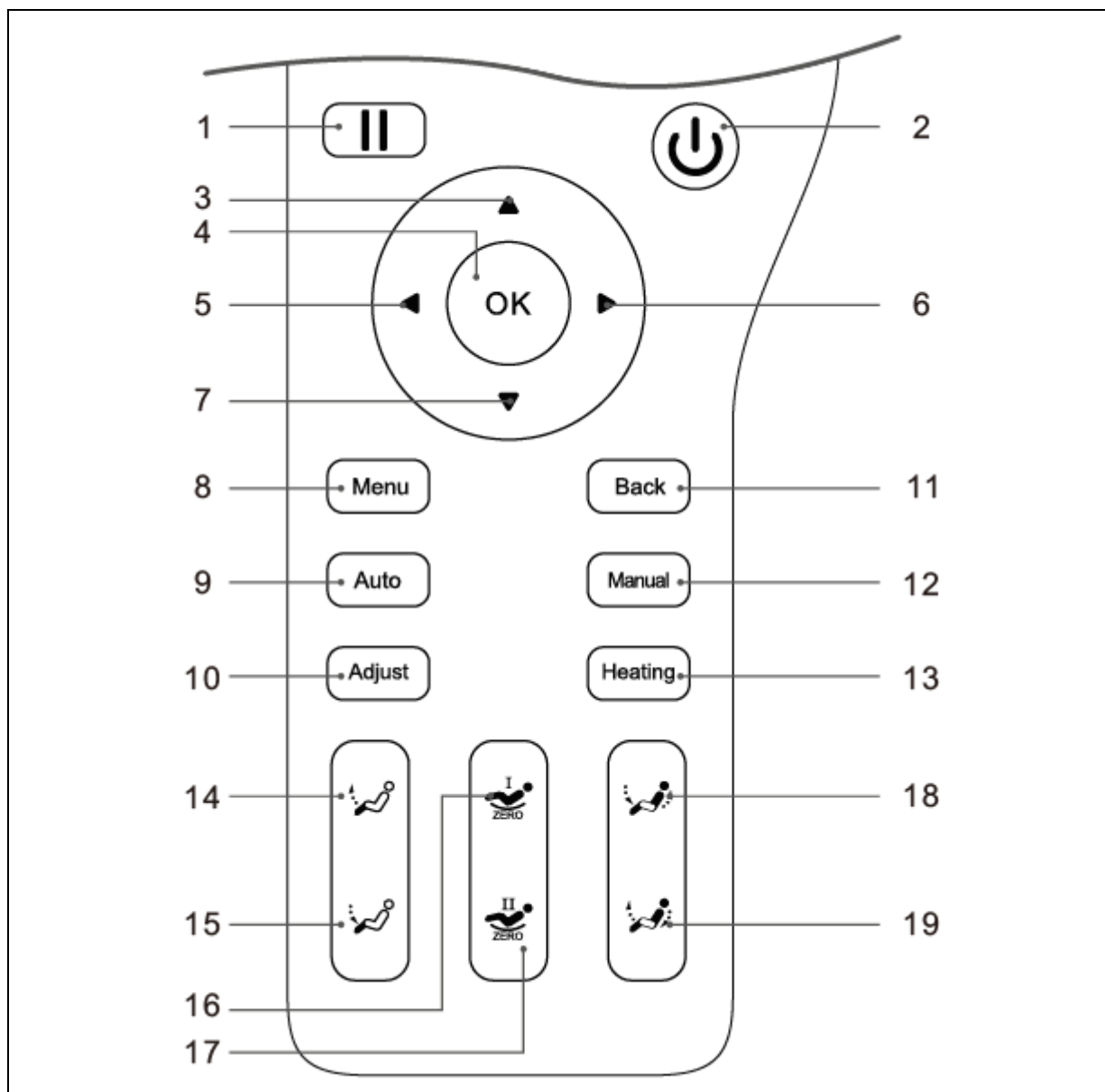

1.	Pause: pause the current massage	11.	Return
2.	Power supply	12.	Manual massage interface
3.	Navigation key up	13.	Heating
4.	Confirm button	14.	Lifting the leg rest
5.	Navigation key left	15.	Lowering leg rest
6.	Right navigation button	16.	Zero gravity setting I
7.	Navigation key down	17.	Zero gravity setting II
8.	Menu	18.	Connected adjustment of the backrests and legs rest
9.	Automatic massage interface	19.	Connected adjustment of the backrests and legs rest
10.	Adjusting		

## USE

### CONNECTION

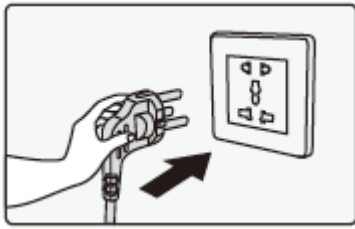

Plug in.

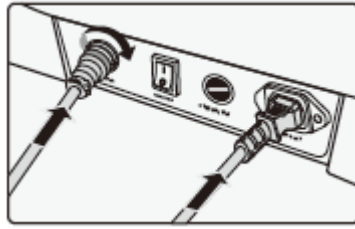

Connect the controller and plug in the power cord.

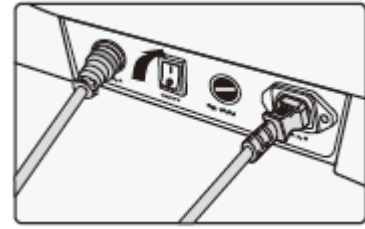

Turn on power switch

### TURN ON

Once turned on, the chair is in standby mode.

Press the power button on the remote control, the backrest stays in its original position, the footrest raises slightly and waits for the automatic massage to be selected. If the massage is not selected within 5 minutes, the chair will automatically switch off.



Once you select any automatic mode, the backrests and legs are adjusted to the preset position.

After adjusting the rests, the chair will automatically detect the shoulders and body shape. Press the confirmation button to skip detection.

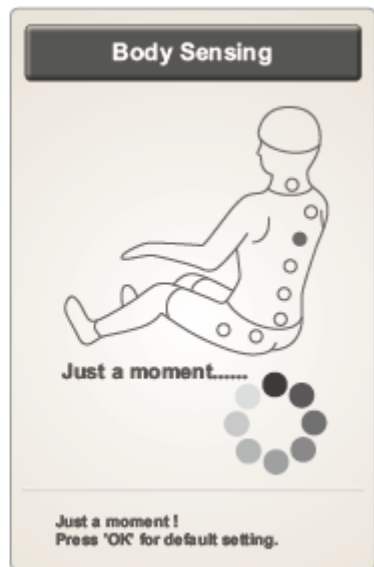
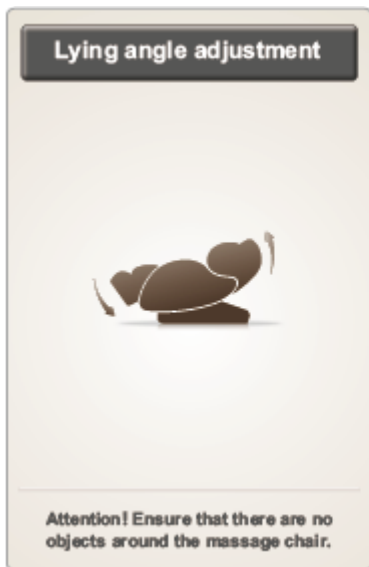

An audible signal sounds when the shoulders are detected. If the position of the massage heads is different from the position of the shoulders, you can adjust the position of the heads using the up and down buttons. You can set up to 11 positions. If the position of the arms is not adjusted within 10 seconds, the massage will start, or press the confirmation button to start immediately. If the chair cannot detect the position of the shoulders, the massage will start with a preset value.

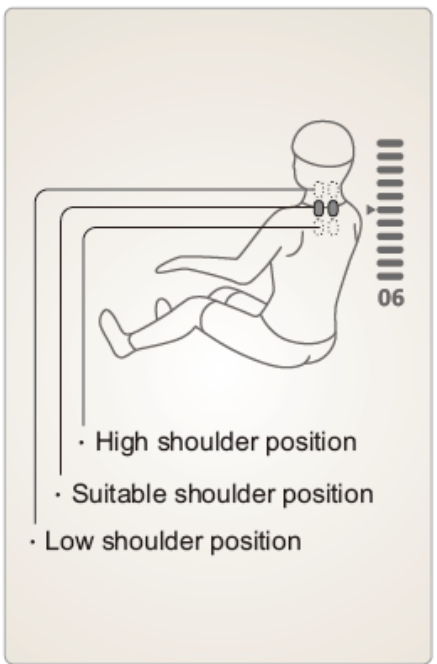

Button	Description
	Massage head up
	Massage head up
	Massage head up

In the interface below you can select "adjust" or "shoulder", after selecting the function press the "ok" button.

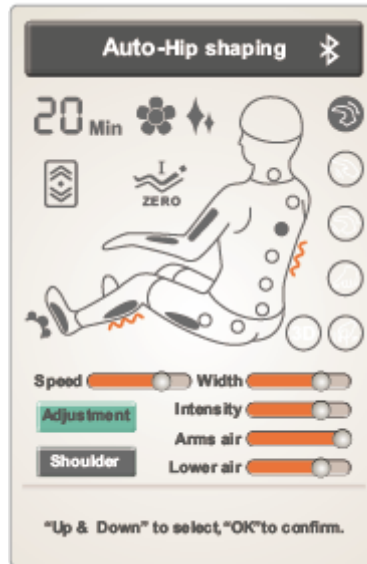

## PAUSE

If you press the "pause" button during the massage, the chair will temporarily stop all functions. Press the function again to start again. If the pause is longer than 20 minutes, the chair switches off.



## MENU

Press "menu" to enter the menu interface. You can choose automatic massage, special massage, manual mode, adjustment, custom massage, settings, display of chair information and others.

Navigate in the menu using the up and down buttons, use the "ok" button to enter. Press "back" to return to the previous interface.

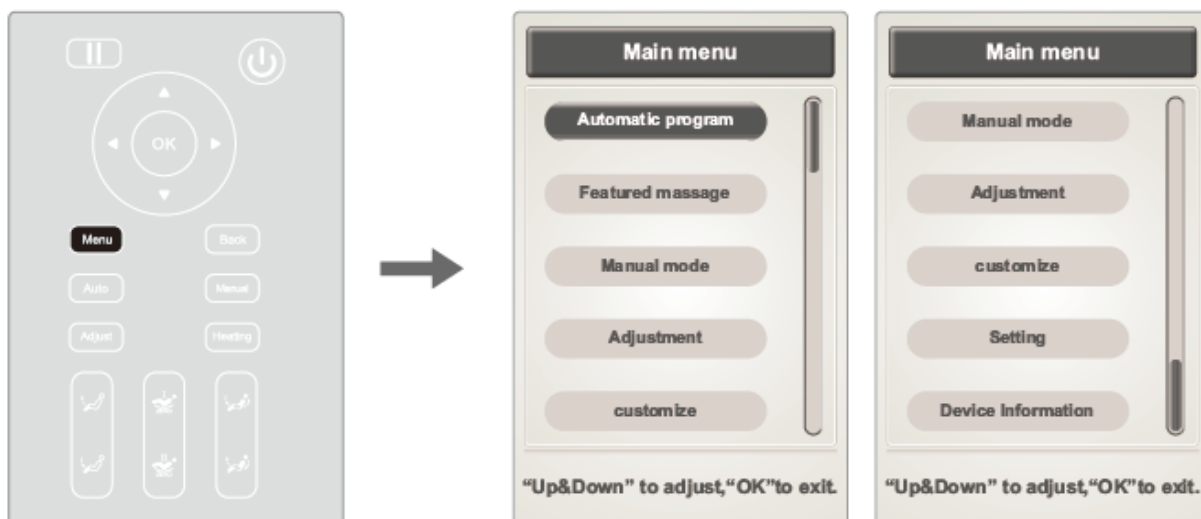

## AUTOMATIC MESSAGE

You can choose an automatic message via the menu or by pressing "auto" on the remote controller. There are 6 messages to choose from: activating collaterals, hip shaping, sleep aid massage, neck & shoulder massage, back waist stretch, breath conditioning.

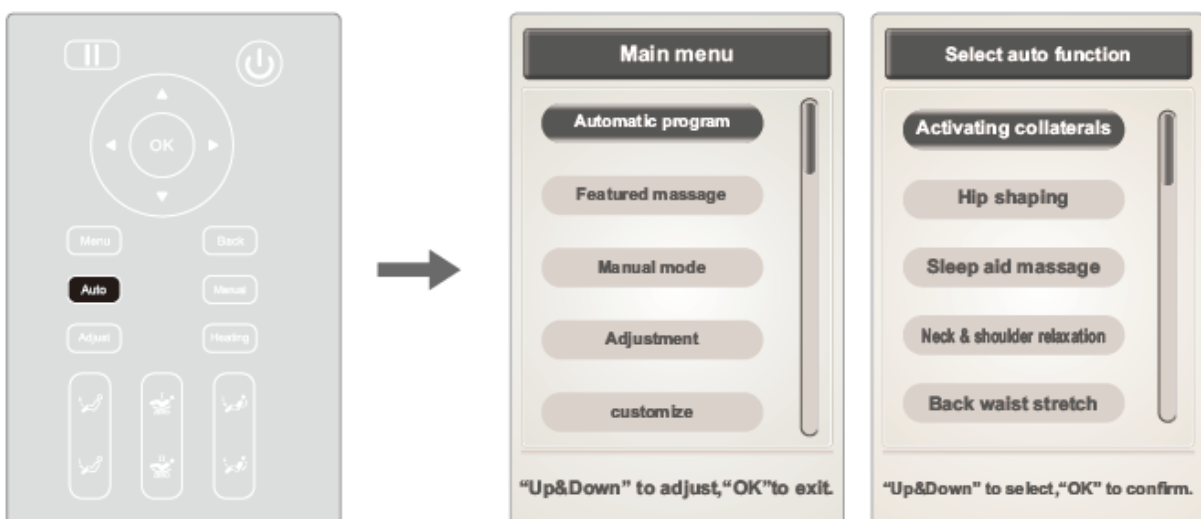

Message	Description
Activating collaterals	Massage of the neck, shoulders, back, waist, buttocks, etc. Massage with the fingers, squeezing and tapping, in combination with foot massage rollers and foot airbags. Full body massage.
Hip shaping	Massage the buttocks and hips with airbags.
Sleep aid massage	Gentle and deep body massage.
Neck & shoulder massage	Neck and shoulder massage, kneading and tapping the shoulders.
Back waist stretch	Back and waist massage using Shiatsu and other techniques.
Breath conditioning	Full body massage using all techniques. The neck, shoulders, back and waist are massaged mainly by kneading and tapping. The waist is also massaged with the fingers.

## SPECIAL AUTOMATIC MESSAGE

In the menu interface, select featured message and choose one of the offered massages: Blue bath therapy, health, music spa.

Navigate in the menu using the up and down buttons, confirm the selection by pressing "Ok".

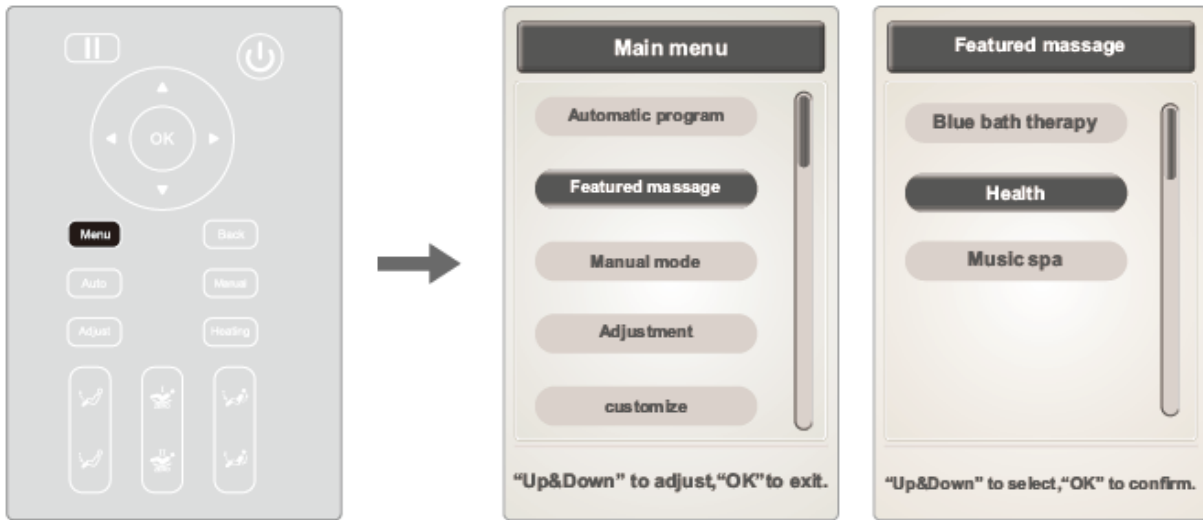

Message	Function
Blue bath therapy	The chair is placed in zero gravity mode and launches the sky with blue light. The kneading massage starts.
Health	The chair is laid down, and the aromatherapy massage is started. The airbag massage is started.
Music SPA	The chair is laid down and combines aromatherapy with full body massage and airbag massage.

## MANUAL MASSAGE

Select "manual mode" in the menu. You can choose the massage technique, which part you want to massage, airbag pressure and other functions.

You can switch between the menus using the right and left buttons. You can navigate in the menu using the up and down buttons. Press the "back" button to return to the previous interface.

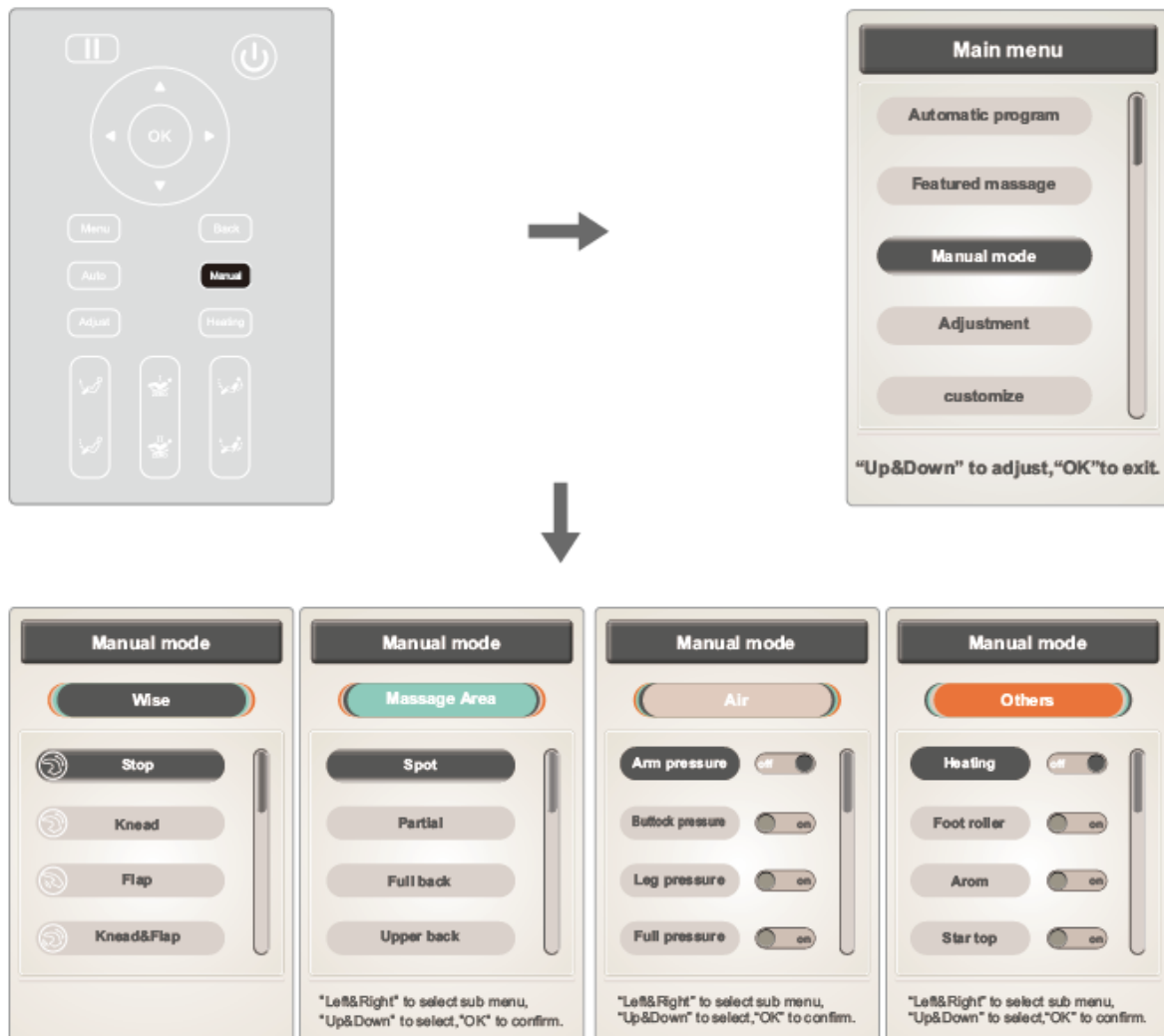

## SELECTING OF MASSAGE TECHNIQUE

There are 6 massage techniques to choose from: 3D massage, kneading, kneading and tapping, shoulder massage, tapping, Shiatsu.

Navigate in the menu using the up and down buttons, confirm the selection by pressing "ok".

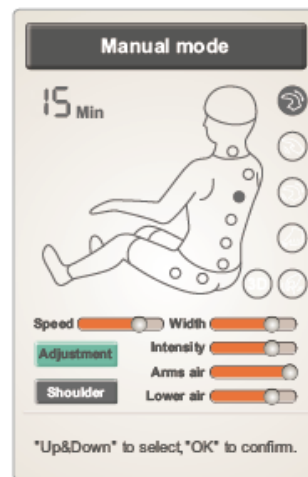

Function	Settings	Display
<b>3D massage</b>	4 types of 3D massages, different speed and intensity.	
<b>kneading</b>	Speed and strength.	
<b>kneading &amp; tapping</b>	Speed and strength.	
<b>shoulder lifting</b>	Speed and strength.	
<b>tapping</b>	2 modes with different speed, width, and intensity.	
<b>Shiatsu</b>	Two types with different speed, width, and intensity.	

Press stop to pause all functions.

### MESSAGE LOCATION

Sport, partial, full back, upper back, lower back, others.

Navigate in the menu using the up and down buttons, confirm the selection by pressing "ok".



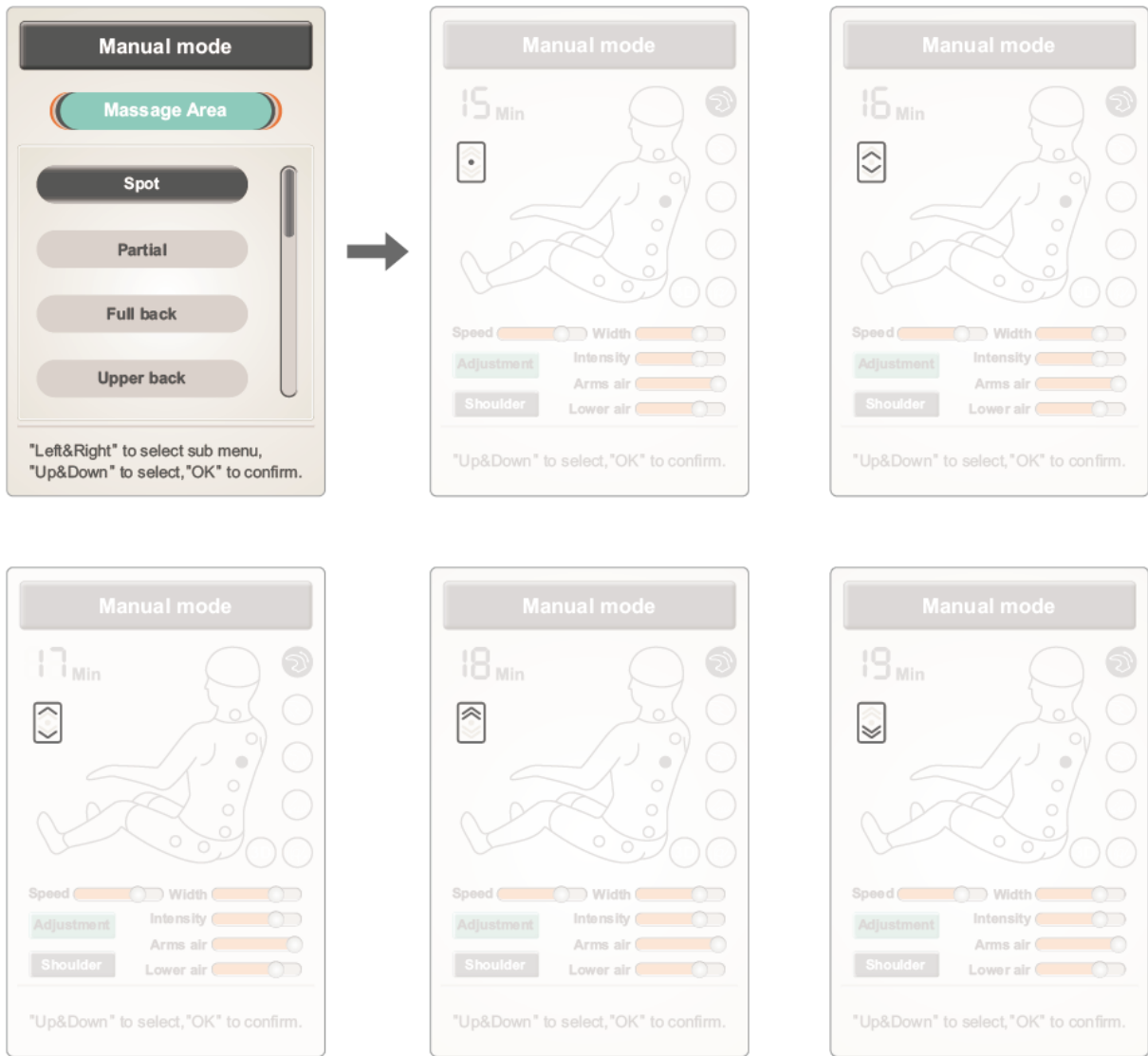

Location	Description
spot	Massage in a fixed place
partial	Massage on a small area
full back	Massage of the back
upper back	Upper back massage
lower back	Lower back massage

### AIRBAGS

You can adjust the airbags of the arms, buttocks, legs and / or a total body massage.

Navigate in the menu using the up and down buttons, confirm the selection by pressing "ok".

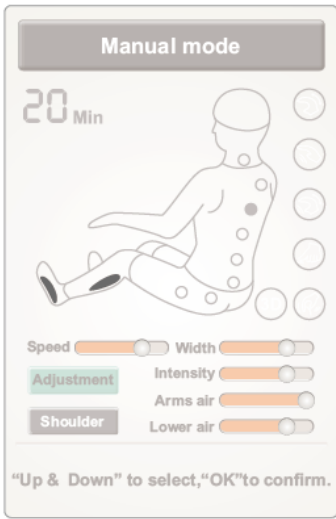
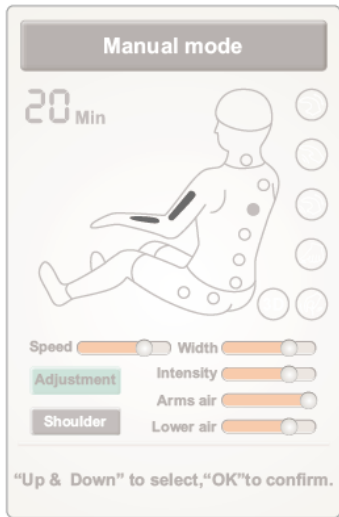

Airbags	Description
<b>Arm</b>	Activate or deactivate the arm airbags
<b>Buttocks</b>	Activate or deactivate the buttock airbags
<b>Legs</b>	Activate or deactivate the foot airbags
<b>Whole body</b>	Activate or deactivate full body airbags

## OTHERS

In the "others" interface you can set the functions of heating, foot massage rollers, aromatherapy, canopy, etc.

Navigate in the menu using the up and down buttons, confirm the selection by pressing "ok".

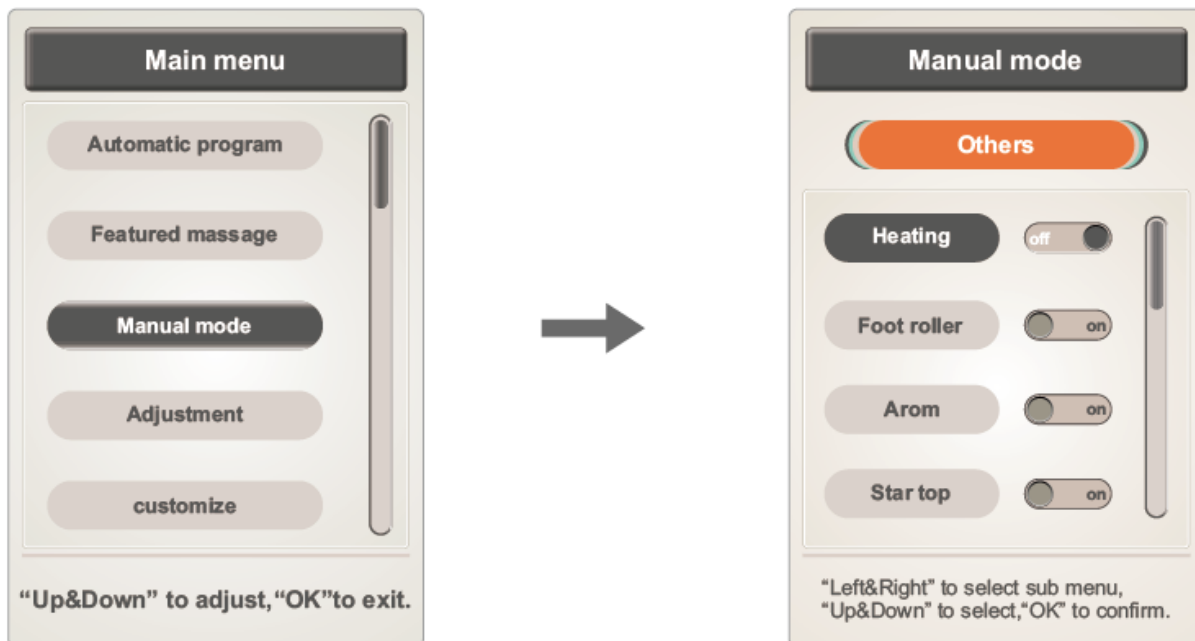

## HEATING

Press "ok" to start or stop the heating, the warm-up time is approximately 3 minutes.

You can also start the function using the quick selection buttons on the chair.

Navigate in the menu using the up and down buttons, press "back" to return.



## FEET ROLLERS

Press "ok" to start or stop foot massage.

Navigate in the menu using the up and down buttons, press "back" to return.

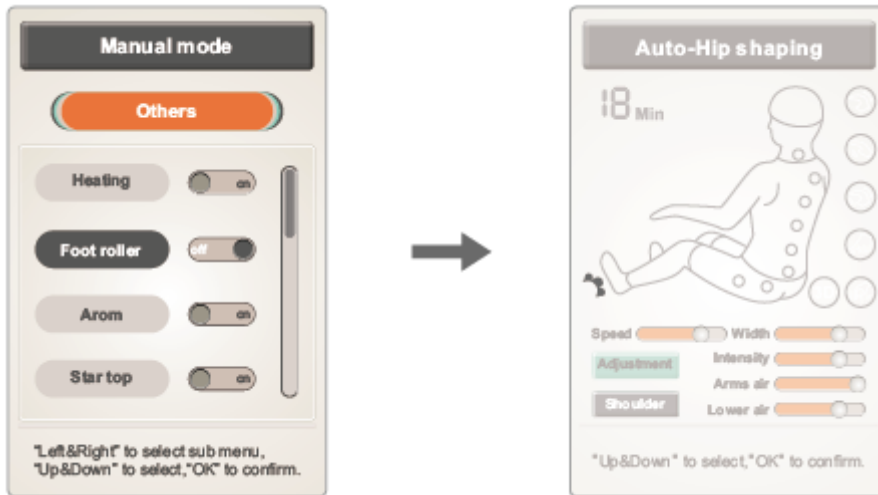

### AROMATHERAPY

Press "ok" to start or stop aromatherapy.

Navigate in the menu using the up and down buttons, press "back" to return.

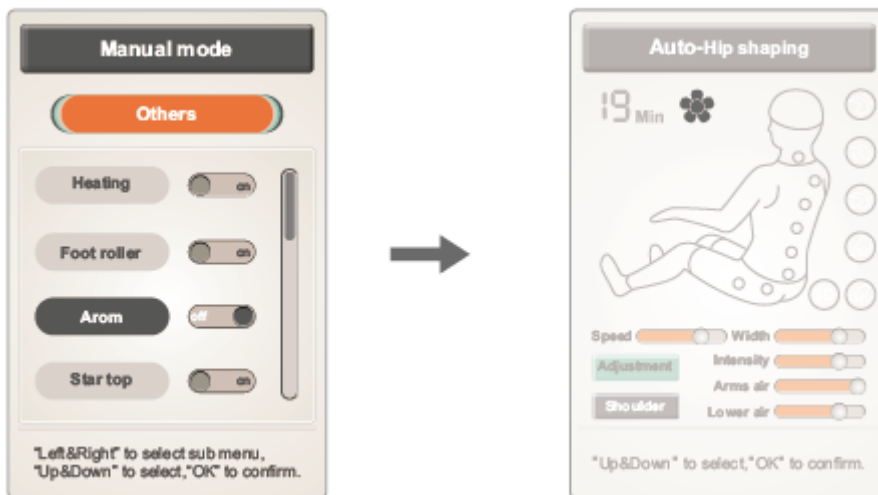

### CANOPY

Press "ok" to start or turn off the canopy.

Navigate in the menu using the up and down buttons, press "back" to return.

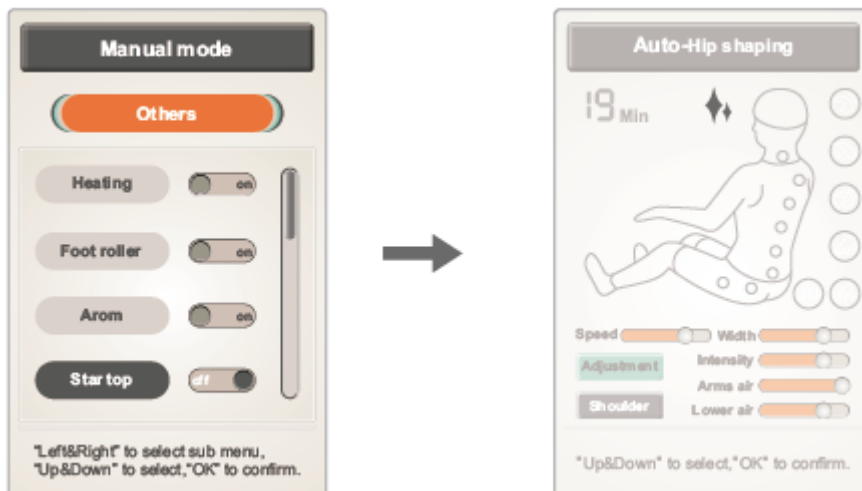

## SPEED, WIDTH AND INTENSITY ADJUSTMENT

You can adjust the values in the categories of massage technique, area, intensity and more.

Use the right and left buttons to move in the submenu, use the up and down buttons to move in the menu.

Confirm the selection by pressing "ok", to return without changes press "back".

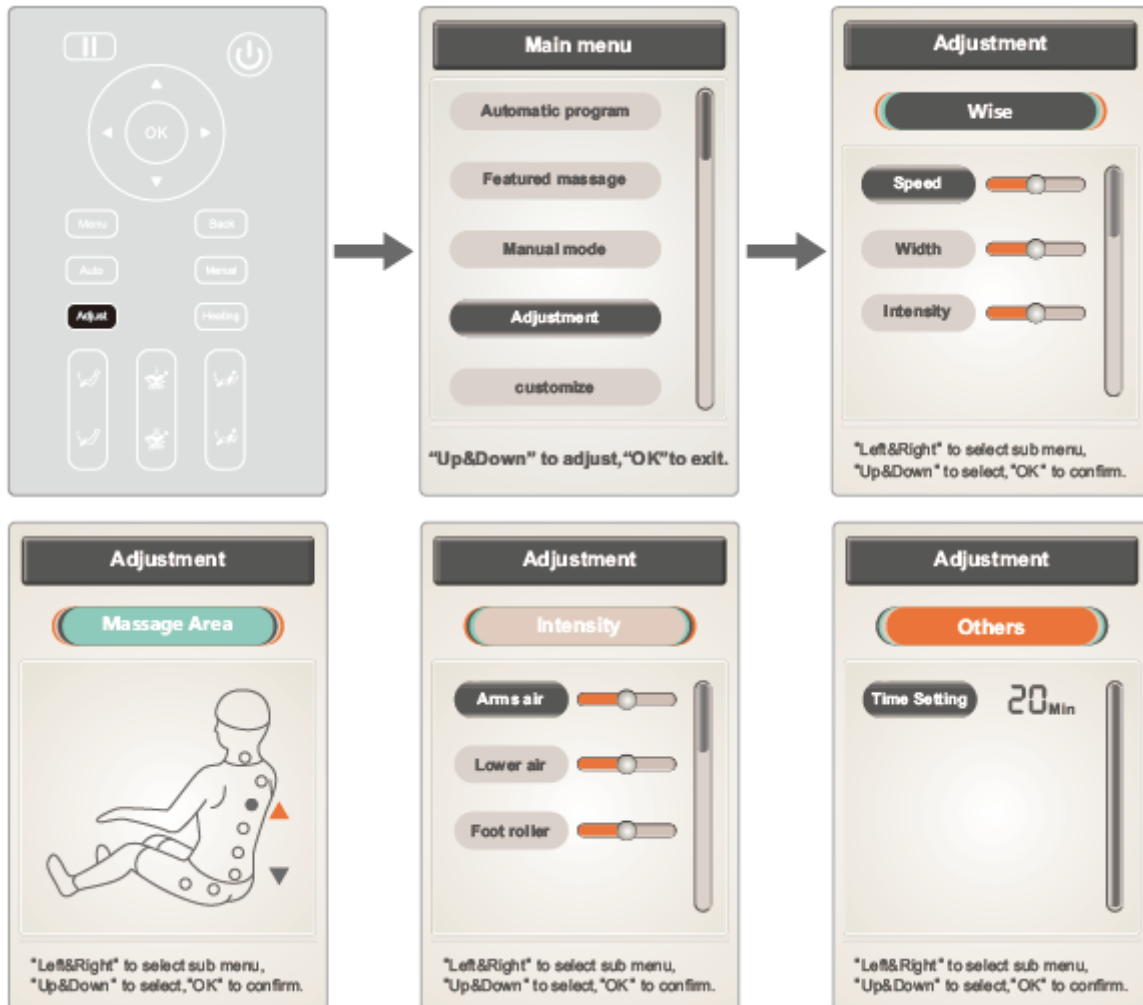

## SPEED AND WIDTH

Use the up and down buttons to adjust the "speed" and the "width", confirm by pressing "ok".

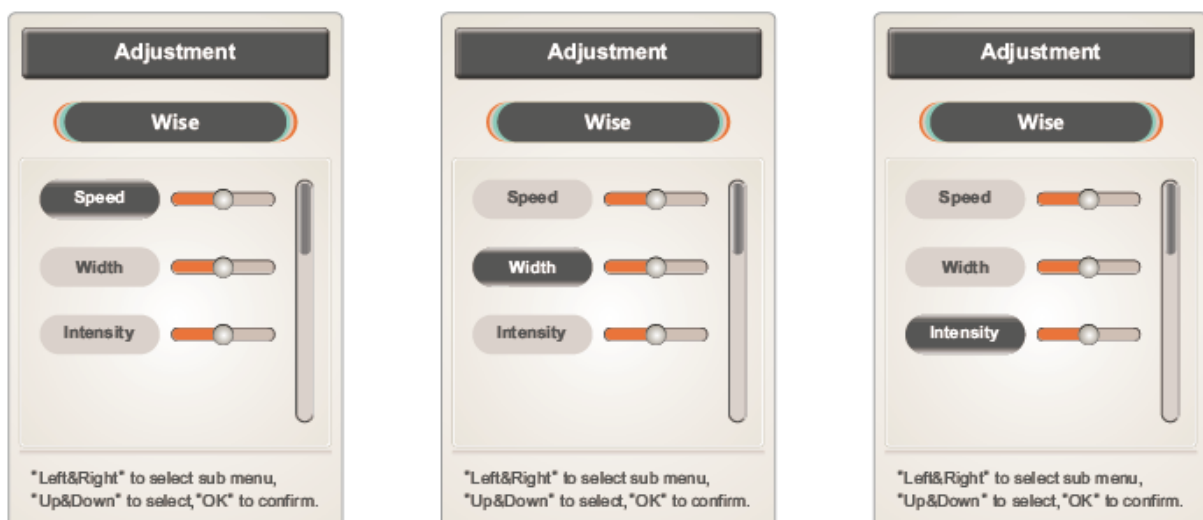

Note: You can adjust 5 speeds, in tapping and Shiatsu modes you can adjust the width - 5 levels.

### MASSAGE AREA

In fixed or partial massage modes, you can move the massage heads by holding the up and down buttons. Release the buttons to stop the movement.

Press the button to change the area.

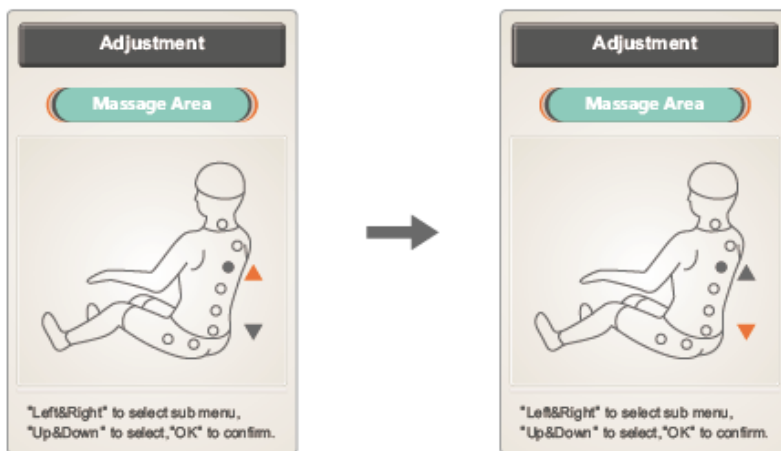

### INTENSITY

You can adjust the intensity of the airbags for the arms, legs and feet.

You can change the intensity using the up and down buttons, confirm by pressing "ok".

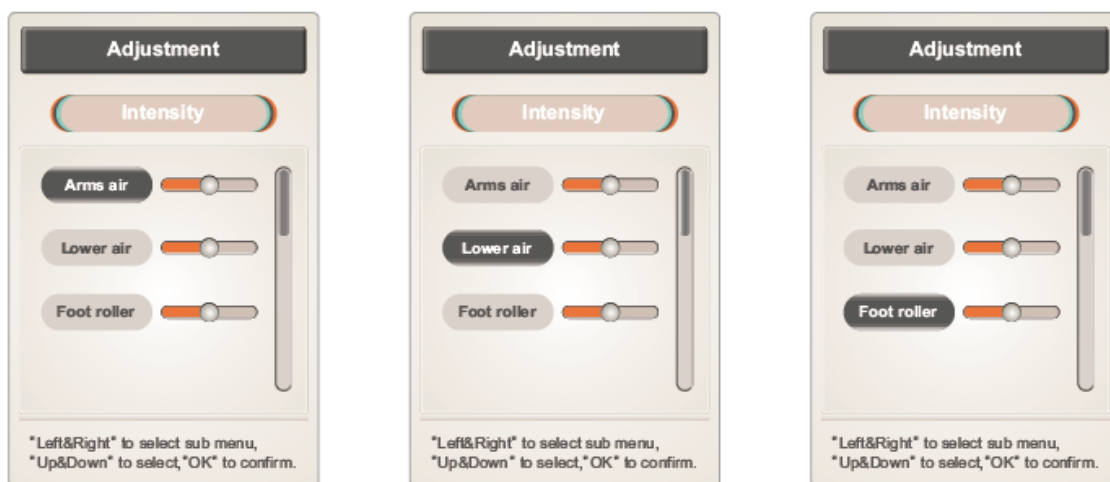

### TIME

Press "ok" to increase the time by 5 minutes to a maximum of 40 minutes. If you exceed 40 minutes, the time will be reduced to 5 minutes.

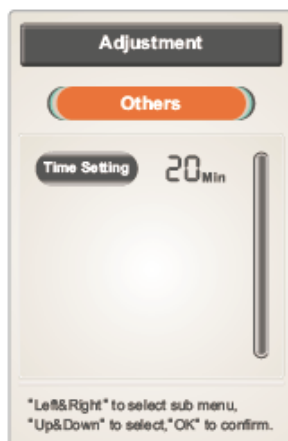

## CUSTOM

You can save your own "custom" message in the menu.

Navigate in the menu with the up and down buttons, select the message with the left and right buttons, confirm with "ok".

You can save up to 3 messages.

Storage: save

Call: load

Press "back" to return to the previous interface.

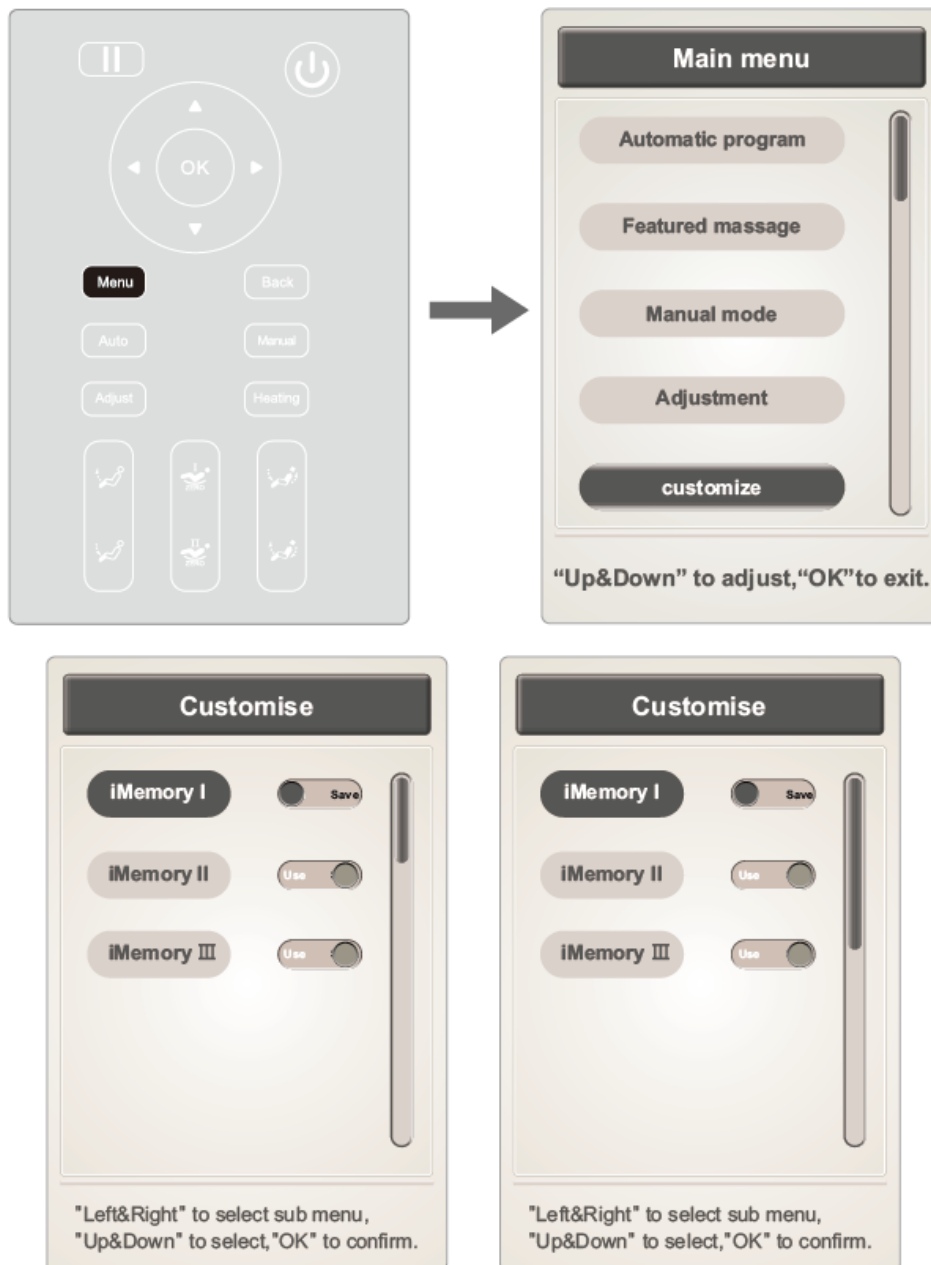

## SETTINGS

Select "settings" in the menu, the "language" settings, the "backlight", the "lock screen" power saving mode are displayed.

Navigate in the menu with the up and down buttons, adjust the settings with the right and left buttons, press "back" to return to the previous interface.

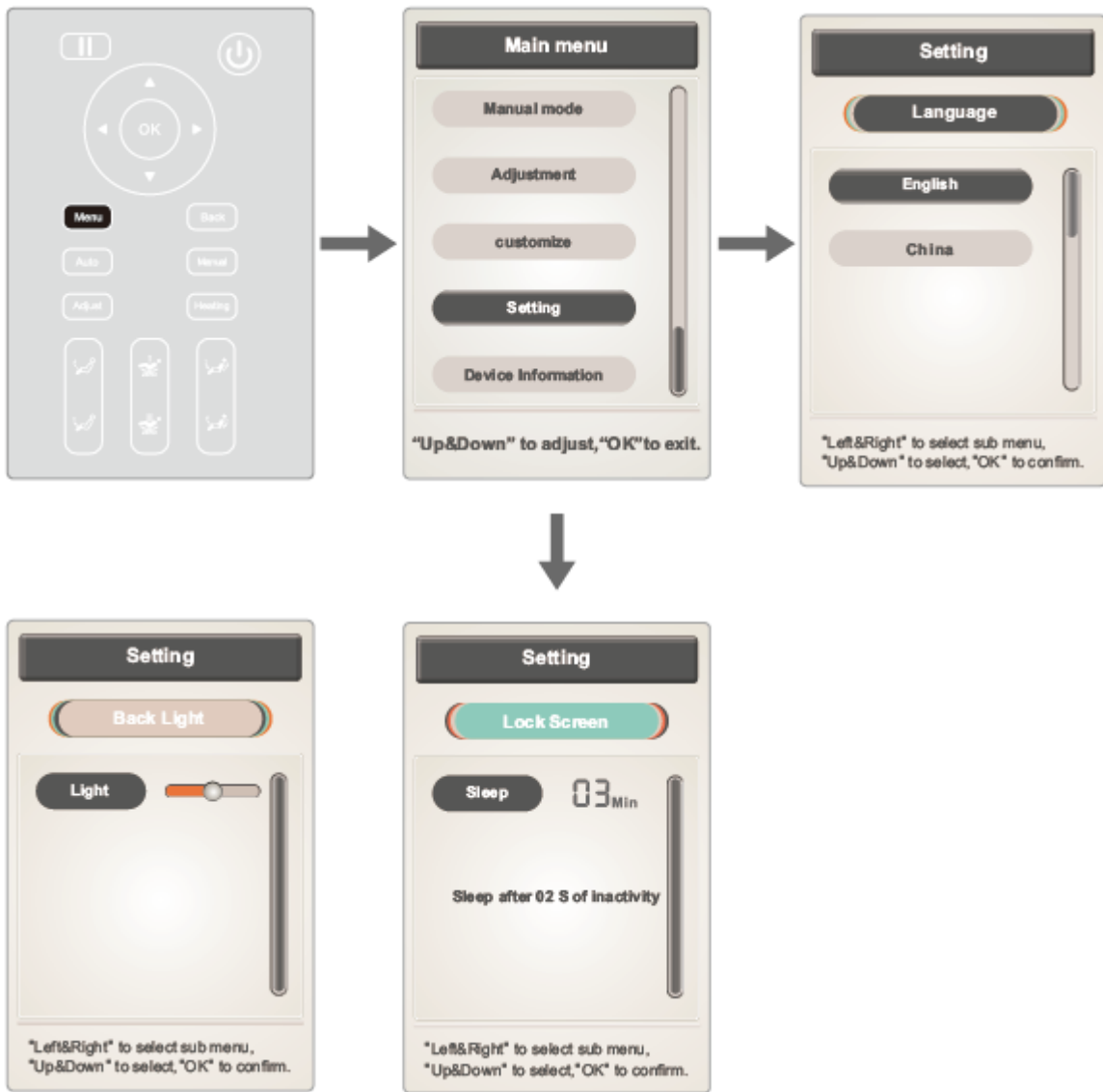

## LANGUAGE

Language: select English or China

In the menu, use the up and down buttons to navigate.

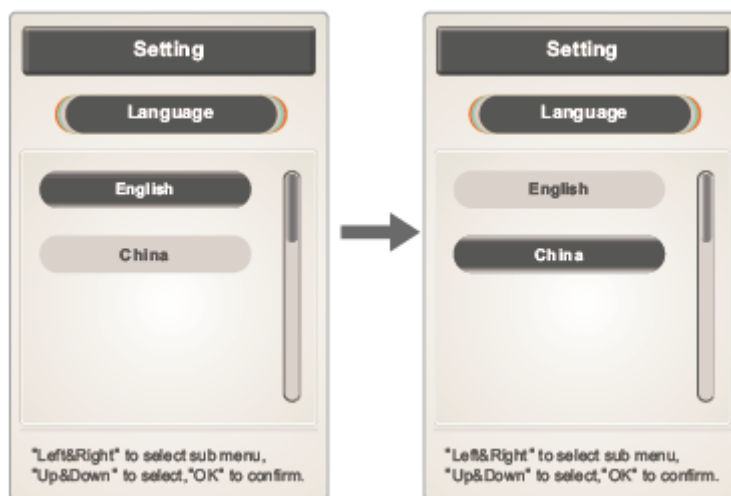



### SWITCHING OFF THE DISPLAY

Lock screen: you can set the time, never turn off the screen, or automatically turn off the display after 2 seconds of inactivity.

To adjust the time, press "ok", you can set 15 seconds, 30 seconds, 1 min, 2 min, 3 min or never switch off.



### BACKLIGHT

You can set 5 levels of backlight.

Press "back" to return to the main menu.



### DEVICE INFORMATION

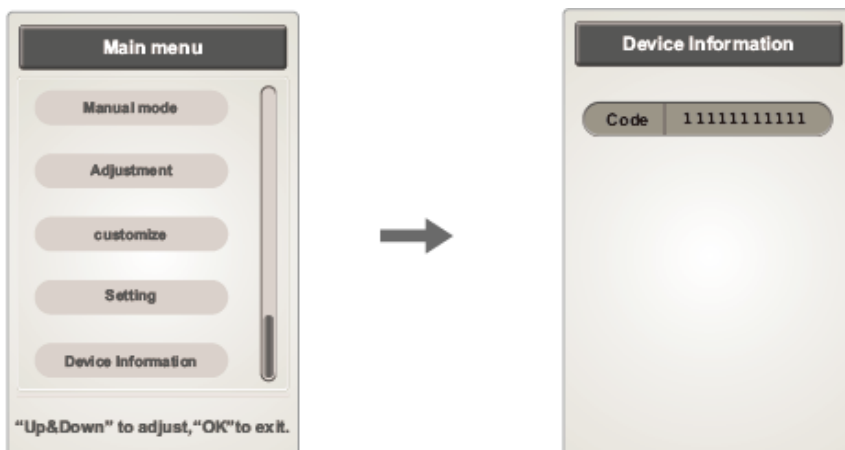

Press "menu" and select "Device information"

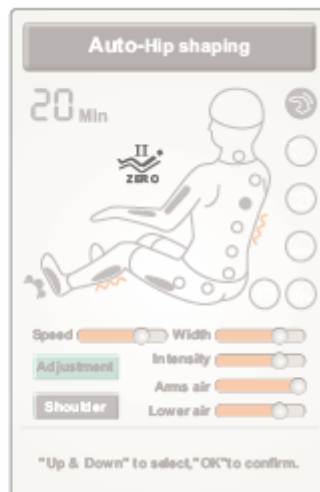
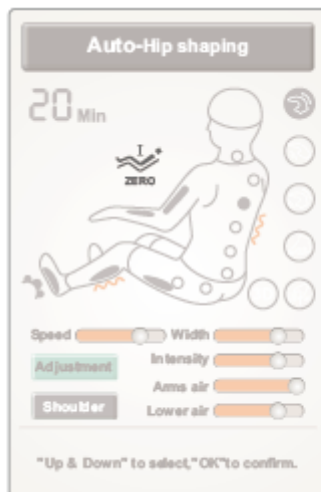

## ZERO-GRAVITY

Press Zero I or Zero II



Function	Description
	Zero gravity I
	Zero gravity II

## HEATING BUTTON

Press the heating button to switch the heating on / off, warm-up takes approx. 3 minutes.

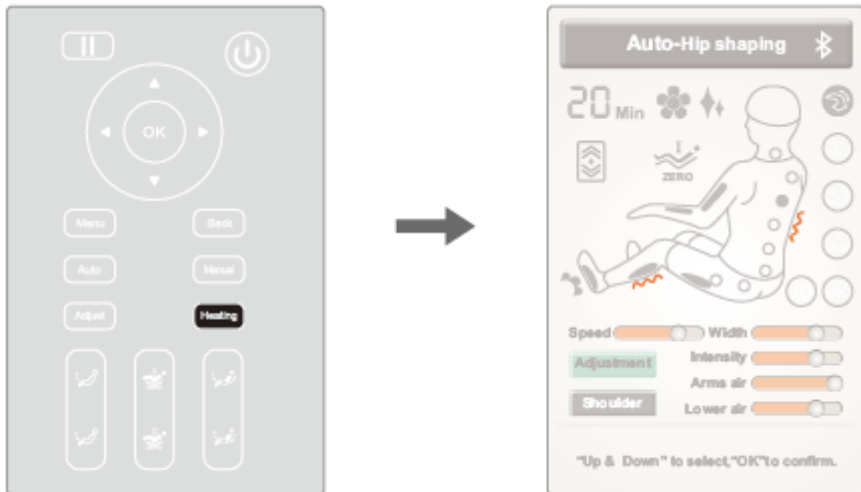



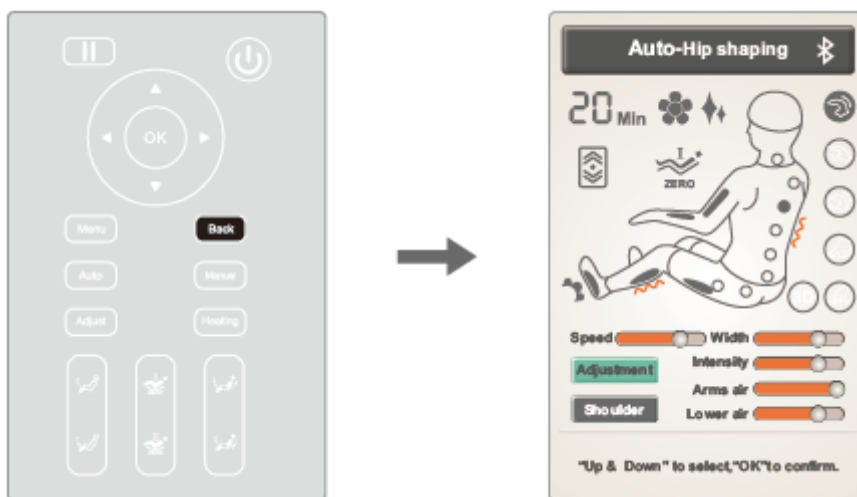

## BACK

The "back" button is used to display information about the massage.













## BUTTONS

### ADJUSTMENTS

Button	Description
	Raising the leg rest: holding down will slowly raise the leg rest, release the button to stop. When finished, the chair detects the length of the legs.
	Lowering the leg rest: holding down will slowly lower the leg rest, release the button to stop. When finished, the chair detects the length of the legs.
	Lowering the leg rest, raising the backrest: holding down will slowly lower the leg rest and raise the backrest, release the button to stop. When finished, the chair detects the length of the legs.
	Raising the leg rest, lowering the backrest: holding down will slowly lower the backrest and raise the leg rest, release the button to stop. When finished, the chair detects the length of the legs.

## QUICK SELECTION BUTTON

Button	Description
	Press to start or stop the massage
	By turning anticlockwise: slowly raise the backrest and lower the leg rest. After adjustment, the chair detects the length of the legs. By turning clockwise: slowly lower the backrest and increase the leg rest. After adjustment, the chair detects the length of the legs
	Press to start / stop heating, heating time approx. 3 minutes.
	Press to start / stop aromatherapy.
	Press to start / stop the heavens.
	Press to start / stop / switch the zero-gravity mode.
	Leg rest extension. Hold to adjust, release to stop.
	Shortening the leg rest. Hold to adjust, release to stop.
<b>AUTO</b>	Selection of automatic massage.
	Air massage mode.
	USB charging port

## SWITCH OFF THE CHAIR

Press the power button to turn off the chair. The massage functions are switched off, the positions of the armrests are switched to the default positions.

To switch off completely, switch off the switch.

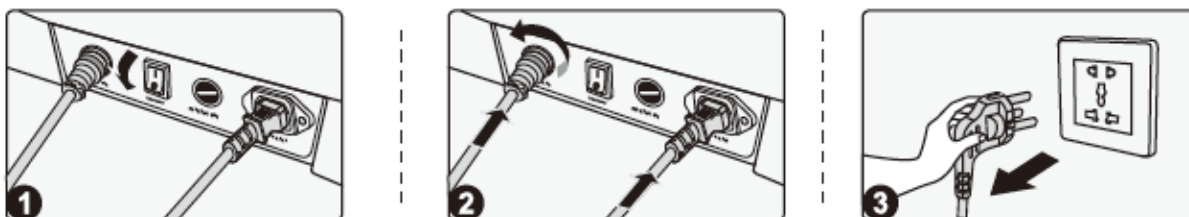

## BLUETOOTH CONNECTION

Turn on the chair and the Bluetooth chair. Then use your smart device to find the chair, the name IMCM-XXXX (X is a unique number), the password is 0000.

## ASSEMBLY

### LEG REST

Pull the cables and hoses out of the chair (Fig. 1).

Connect the cables and hoses, insert the cables and hoses into the chair, do not pinch them (Fig. 2).

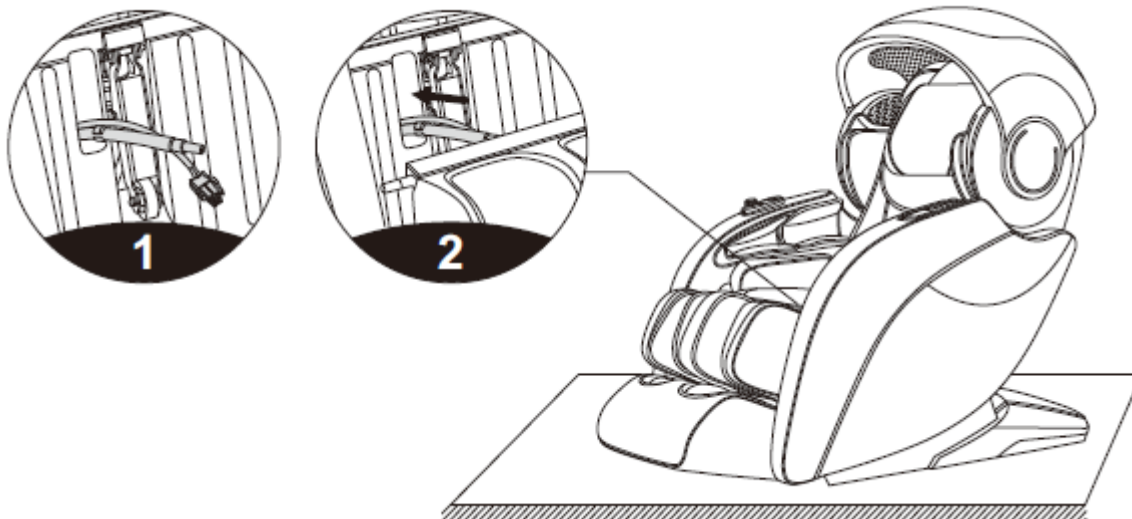

Attach the sleeves to the brackets (the larger sleeve must be on the outside) (Fig. 3).

Pull out the holder (Fig. 4).

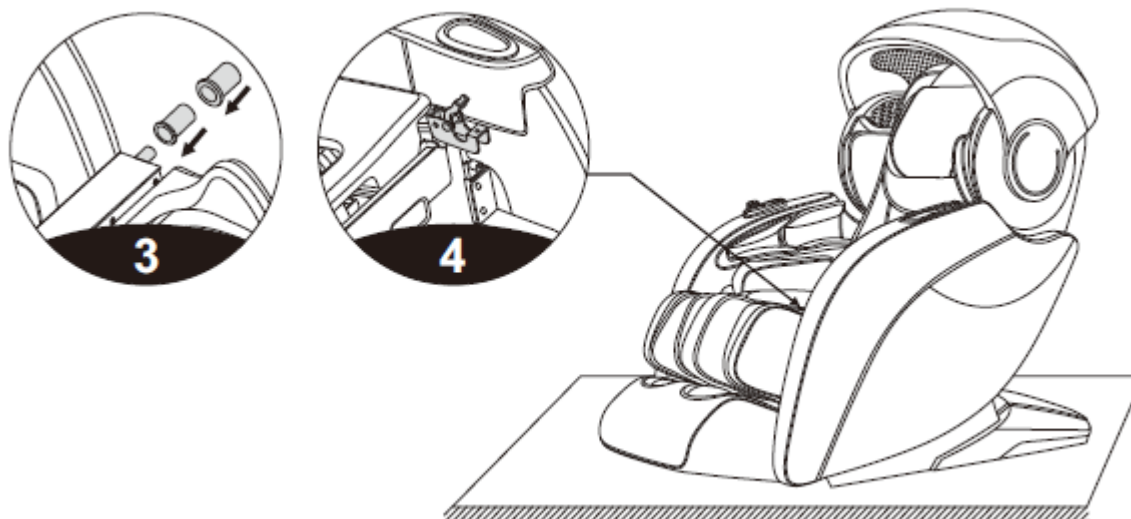

Attach the leg rest to the bracket (Fig. 5).

Attach the leg rest with 2x M5x 14 - 12.9 screws and 2x 6 x 12x 1.5 washers (Fig. 6).

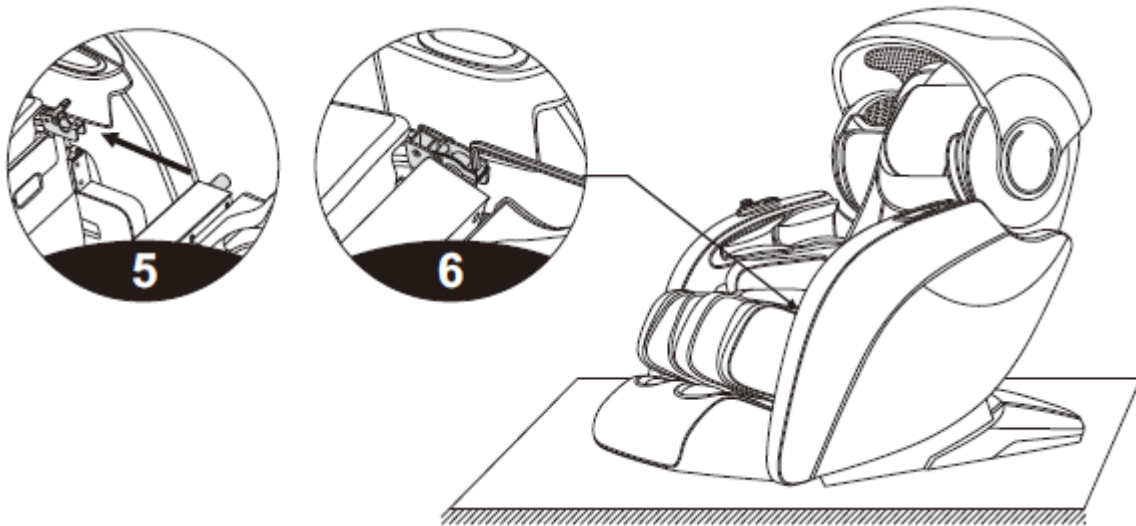

Attach the bracket cover (Fig. 7).

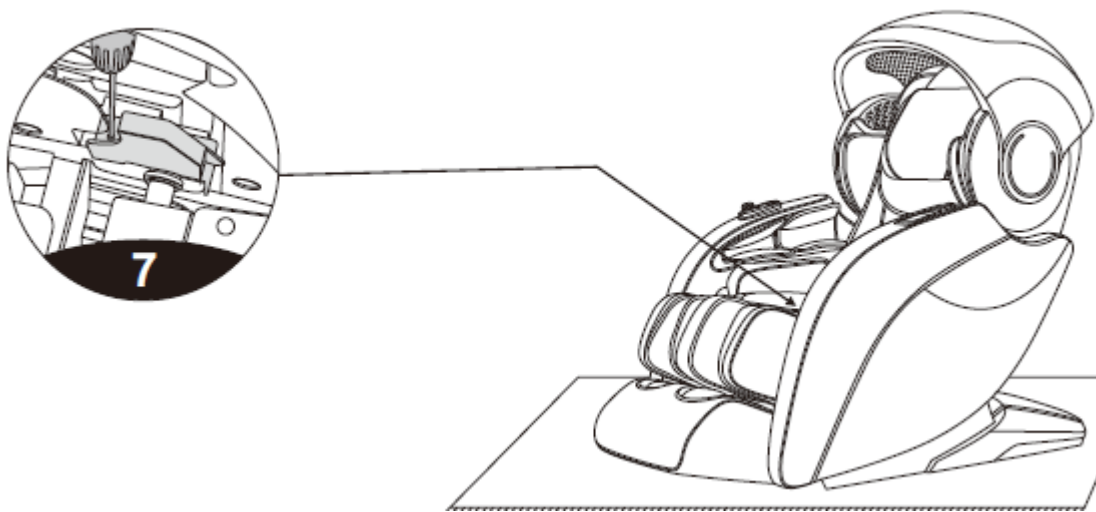

## AROMATHERAPY

Lower the canopy (Fig. 1).

Turn the knob and pull out the aromatherapy (Fig. 2).

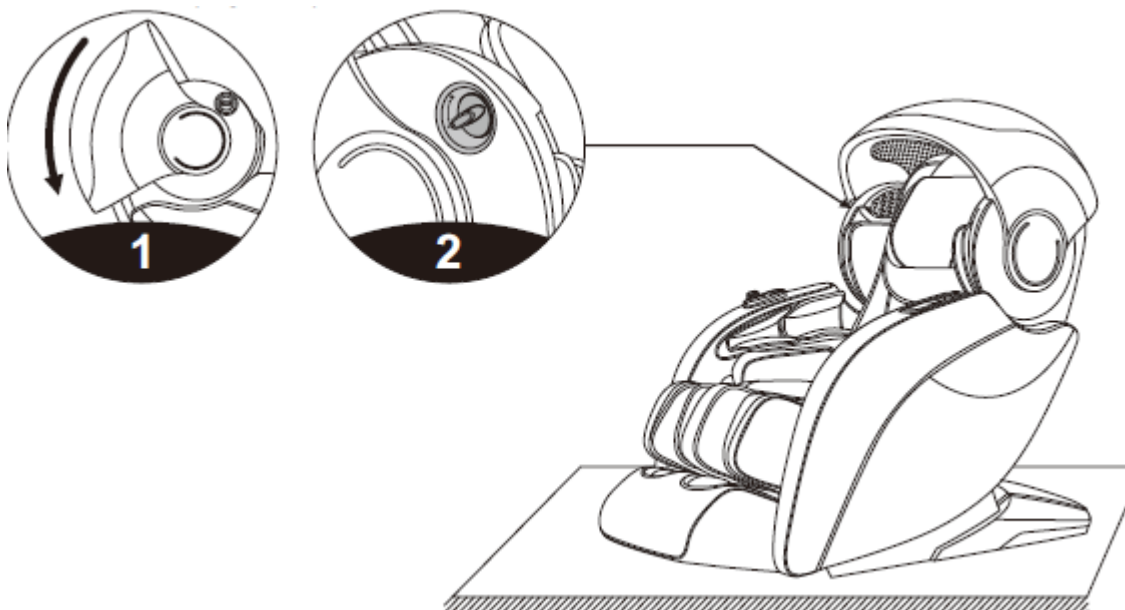

Replace aromatherapy and reattach (Fig. 3).

Make sure it is properly secured (Fig. 4).

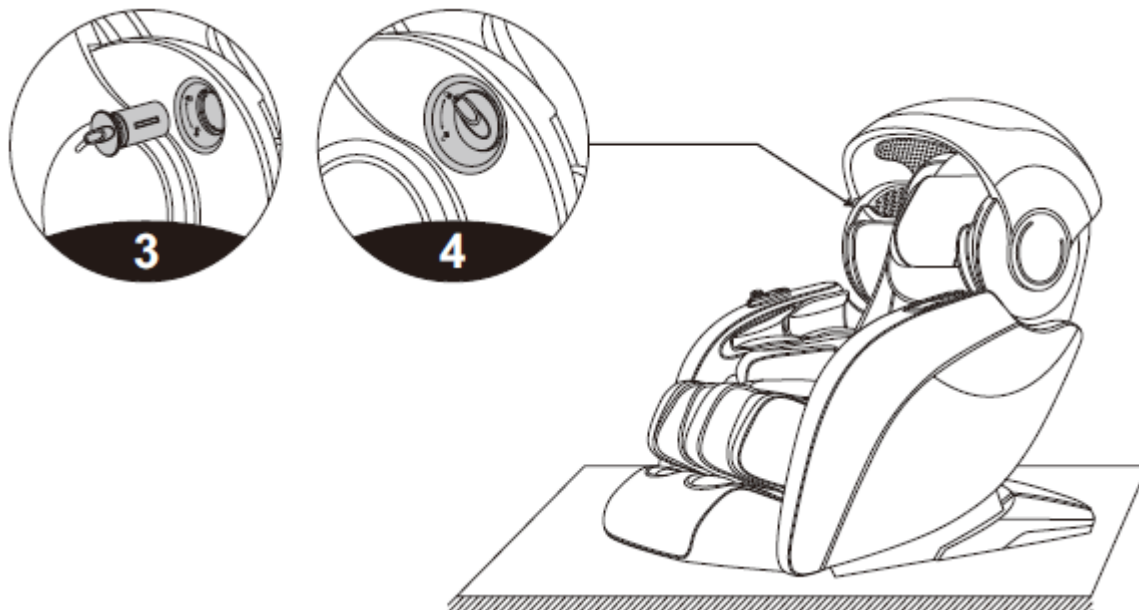

## PILLOWS

The cushions are fastened with a zipper for the backrest (1), the cushions for the headrest with Velcro (2).

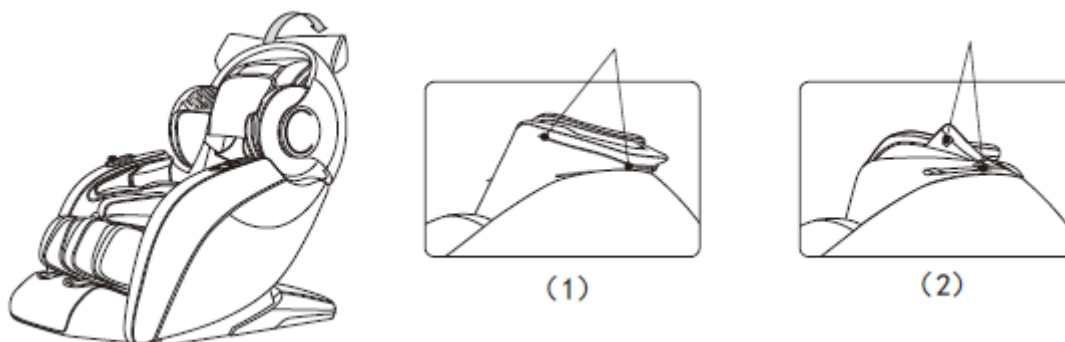

## FLOOR PROTECTION

We recommend using floor protection such as carpets or mats. The weight of the chair could damage the wooden floor.

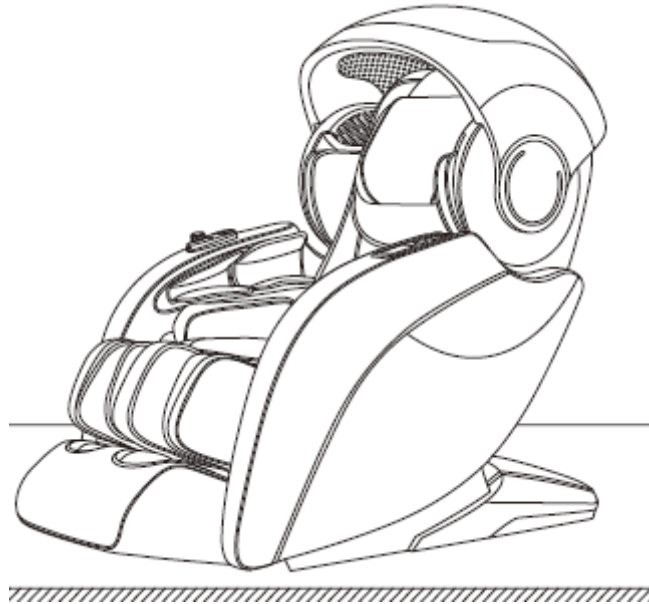

## TRANSPORT

Before moving, make sure that you have switched off the chair and pulled it out of the socket.

You need at least two people to move.

Lift the chair by the sides.

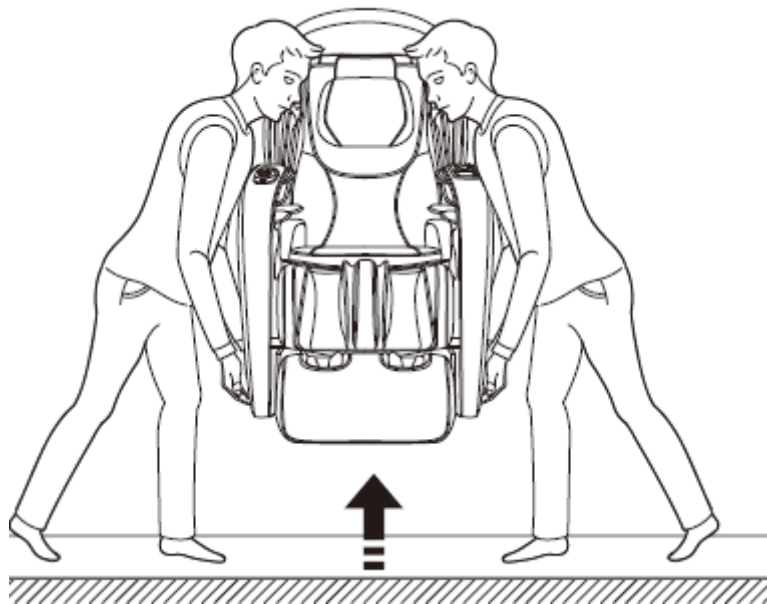

## SPECIFICATIONS

Model:	A802
Configuration:	1
Name:	Massage armchair
Rated voltage:	110-120V 60 Hz 220-240V 50Hz / 60Hz
Rated power input	260 W
Operation time	20 min
Safety:	Class I



## ENVIRONMENT PROTECTION

After the product lifespan expired or if the possible repairing is uneconomic, dispose it according to the local laws and environmentally friendly in the nearest scrapyard.

By proper disposal you will protect the environment and natural sources. Moreover, you can help protect human health. If you are not sure in correct disposing, ask local authorities to avoid law violation or sanctions.

Don't put the batteries among house waste but hand them in to the recycling place.

## TERMS AND CONDITIONS OF WARRANTY, WARRANTY CLAIMS

### General Conditions of Warranty and Definition of Terms

All Warranty Conditions stated here under determine Warranty Coverage and Warranty Claim Procedure. Conditions of Warranty and Warranty Claims are governed by Act No. 89/2012 Coll. Civil Code, and Act No. 634/1992 Coll., Consumer Protection, as amended, also in cases that are not specified by these Warranty rules.

The seller is SEVEN SPORT s.r.o. with its registered office in Strakonická street 1151/2c, Prague 150 00, Company Registration Number: 26847264, registered in the Trade Register at Regional Court in Prague, Section C, Insert No. 116888.

According to valid legal regulations it depends whether the Buyer is the End Customer or not.

“The Buyer who is the End Customer” or simply the “End Customer” is the legal entity that does not conclude and execute the Contract in order to run or promote his own trade or business activities.

“The Buyer who is not the End Customer” is a Businessman that buys Goods or uses services for the purpose of using the Goods or services for his own business activities. The Buyer conforms to the General Purchase Agreement and business conditions.

These Conditions of Warranty and Warranty Claims are an integral part of every Purchase Agreement made between the Seller and the Buyer. All Warranty Conditions are valid and binding, unless otherwise specified in the Purchase Agreement, in the Amendment to this Contract or in another written agreement.

### Warranty Conditions

#### Warranty Period

The Seller provides the Buyer a 24 months Warranty for Goods Quality, unless otherwise specified in the Certificate of Warranty, Invoice, Bill of Delivery or other documents related to the Goods. The legal warranty period provided to the Consumer is not affected.

By the Warranty for Goods Quality, the Seller guarantees that the delivered Goods shall be, for a certain period of time, suitable for regular or contracted use, and that the Goods shall maintain its regular or contracted features.

### Batteries

6-month battery warranty – we guarantee that battery's nominal capacity does not fall below 70% of its total capacity within 6 months of the product's sale.

### The Warranty does not cover defects resulting from (if applicable):

- User's fault, i.e. product damage caused by unqualified repair work, improper assembly, insufficient insertion of seat post into frame, insufficient tightening of pedals and cranks
- Improper maintenance
- Mechanical damages
- Regular use (e.g. wearing out of rubber and plastic parts, moving mechanisms, joints, wear of brake pads/blocks, chain, tires, cassette/multi wheel etc.)
- Unavoidable event, natural disaster

- Adjustments made by unqualified person
- Improper maintenance, improper placement, damages caused by low or high temperature, water, inappropriate pressure, shocks, intentional changes in design or construction etc.

### **Warranty Claim Procedure**

The Buyer is obliged to check the Goods delivered by the Seller immediately after taking the responsibility for the Goods and its damages, i.e. immediately after its delivery. The Buyer must check the Goods so that he discovers all the defects that can be discovered by such check.

When making a Warranty Claim the Buyer is obliged, on request of the Seller, to prove the purchase and validity of the claim by the Invoice or Bill of Delivery that includes the product's serial number, or eventually by the documents without the serial number. If the Buyer does not prove the validity of the Warranty Claim by these documents, the Seller has the right to reject the Warranty Claim.

If the Buyer gives notice of a defect that is not covered by the Warranty (e.g. in the case that the Warranty Conditions were not fulfilled or in the case of reporting the defect by mistake etc.), the Seller is eligible to require a compensation for all the costs arising from the repair. The cost shall be calculated according to the valid price list of services and transport costs.

If the Seller finds out (by testing) that the product is not damaged, the Warranty Claim is not accepted. The Seller reserves the right to claim a compensation for costs arising from the false Warranty Claim.

In case the Buyer makes a claim about the Goods that is legally covered by the Warranty provided by the Seller, the Seller shall fix the reported defects by means of repair or by the exchange of the damaged part or product for a new one. Based on the agreement of the Buyer, the Seller has the right to exchange the defected Goods for a fully compatible Goods of the same or better technical characteristics. The Seller is entitled to choose the form of the Warranty Claim Procedures described in this paragraph.

The Seller shall settle the Warranty Claim within 30 days after the delivery of the defective Goods, unless a longer period has been agreed upon. The day when the repaired or exchanged Goods is handed over to the Buyer is considered to be the day of the Warranty Claim settlement. When the Seller is not able to settle the Warranty Claim within the agreed period due to the specific nature of the Goods defect, he and the Buyer shall make an agreement about an alternative solution. In case such agreement is not made, the Seller is obliged to provide the Buyer with a financial compensation in the form of a refund.

#### **CZ SEVEN SPORT s.r.o.**

Registered Office: Strakonická 1151/2c, Praha 5, 150 00, ČR  
Headquarters: Dělnická 957, Vítkov, 749 01  
Warranty & Service: Čermenská 486, Vítkov 749 01

CRN: 26847264  
VAT ID: CZ26847264

Phone: +420 556 300 970  
E-mail: eshop@insportline.cz  
reklamace@insportline.cz  
servis@insportline.cz

Web: www.inSPORTline.cz

#### **SK inSPORTline s.r.o.**

Headquarters, warranty & service center: Električná 6471, Trenčín 911 01, SK

CRN: 36311723  
VAT ID: SK2020177082

Phone: +421(0)326 526 701  
E-mail: objednavky@insportline.sk  
reklamacie@insportline.sk  
servis@insportline.sk

Web: www.inSPORTline.sk