



USER MANUAL – EN
IN 19888 E-scooter inSPORTline Fulmino



CONTENTS

SAFETY INSTRUCTIONS.....	3
PRODUCT DESCRIPTION	4
CONTROL PANEL	4
ASSEMBLY	5
FOLDING AND CARRYING	5
FOLDING	5
CARRYING	5
CHARGING	6
BATTERY.....	6
HOW TO RIDE	6
MAINTENANCE	7
BRAKES.....	7
TIRES.....	7
CLEANING.....	7
STORAGE	8
TECHNICAL PARAMETERS	8
ENVIRONMENT PROTECTION	9
TERMS AND CONDITIONS OF WARRANTY, WARRANTY CLAIMS.....	9

SAFETY INSTRUCTIONS

- The scooter is designed to carry one person at the same time.
- Wear a helmet and other protective equipment, incl. proper boots.
- Do not ride on dangerous or ineligible roads.
- Before the first ride, try to control the scooter in the open spaces. If you are not sure, ask a more experienced person for advice.
- Avoid dangerous maneuvers or one-hand steering while riding.
- When riding, keep both feet on the footboard.
- Do not drive directly over an obstacle higher than 3 cm, otherwise you can lose balance and cause yourself injury or damage to the product.
- On uneven or bumpy roads, slow down and ride with caution. Do not endanger yourself or others by careless riding.
- Before riding, it is necessary to set the correct handlebar height for your safety.
- Do not ride into the water, oil or on frozen surfaces.
- Do not immerse the scooter in water. The battery or motor will be destroyed.
- If possible, do not ride in poor weather conditions. Be extra caution during dark.
- Always make sure that you do not violate local regulations and laws before using the product. The use of these and similar devices is not permitted everywhere. If in doubt, contact your local authorities.
- Check that all parts are well held and the screws are not loosened. Ex. tighten them or contact a service center.
- Unauthorized modifications or maintenance will reduce the safety of the equipment.
- Improper use can lead to serious (fatal) injury or damage.
- Check the product regularly for wear. Replace worn parts immediately.
- Do not use a damaged product. Do not use the product if sharp edges appear.
- Follow the manual for maintenance and use. Do not disassemble the device yourself.
- Check the battery level before riding. If it is not fully charged, do not start riding.
- The device is for personal use only. Commercial use is not allowed.
- Be careful while riding. Never ride after drinking alcohol or under the influence of drugs. Do not carry anything on the device.
- Always keep the speed under control and be careful. Keep good vision around the area. Do not exceed speed or weight limits to avoid injury.
- Keep your feet relaxed and your knees slightly bent when riding on an uneven surface.
- In the event of an accident, do not leave and wait for assistance.
- When riding in a group, keep a sufficient distance to avoid collision.
- Remember that your current height is greater when standing on the scooter than without it. Try to keep your balance and avoid too narrow places.
- Other activities (phoning, listening to music) can significantly reduce your riding attention. Don't be distracted.
- Check the condition of the tires regularly. Replace worn out immediately.
- To avoid damaging electrical components, do not immerse the scooter in water or drive through water deeper than 3 cm and do not wash it under running water.

- Weight limit: 100 kg
- Product meets standards: EN ISO 12100:2010, EN 12184:2014, EN 61000-6-1:2007, EN 61000-6-3:2007+A1:2011+AC:2012

PRODUCT DESCRIPTION

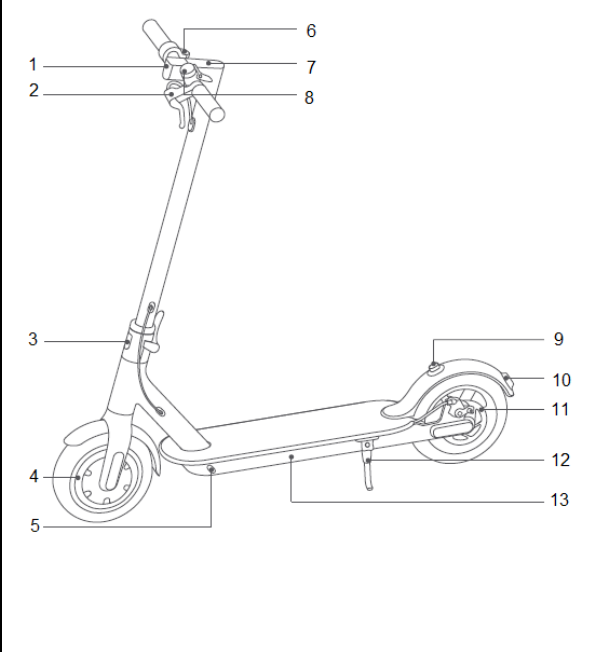
	1. Lights
	2. Brakes
	3. Folding mechanism
	4. Wheel motor
	5. Charging port
	6. Accelerator
	7. Control panel
	8. Bell
	9. Buckle
	10. Brake light
	11. Disc brakes
	12. Kickstand
	13. Battery

CONTROL PANEL

	1. Display - shows the current speed while riding
	2. Displaying the current speed mode - the green light will light up when you turn on the scooter. When the green light is on, the maximum speed of the scooter is 15 km / h. Press the button twice, the color changes to white (fast mode) and the maximum speed is 20 km / h.
	3. Battery Indicator - The number of lights indicates the battery level, if all the lights are on, the battery is fully charged. If half of the lights is on, the battery is half full.
	4. Switching on / off - Press this button briefly to switch on the scooter. Holding the button down for 2 seconds turns off the scooter. If the scooter is on, briefly press to turn the lights on / off.

ASSEMBLY

1. Secure the steering rod and place the scooter on the stand.
2. Attach the handlebar to the control rod.
3. Secure the handlebar with the Allen screws.
4. After assembly, turn on the scooter.

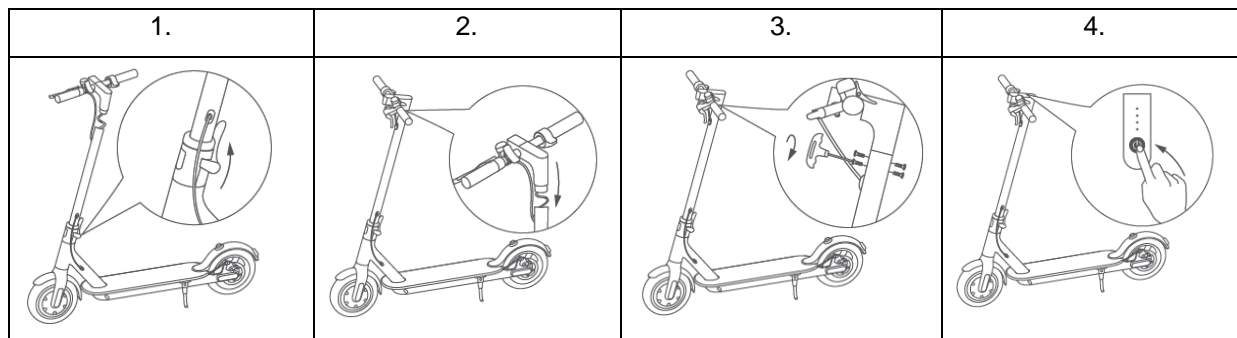

FOLDING AND CARRYING

FOLDING

Turn off the scooter. Then release the quick release mechanism and then secure the buckles on the fender.

To disassemble, you must press the buckle lock and then secure the control rod with the quick release mechanism.

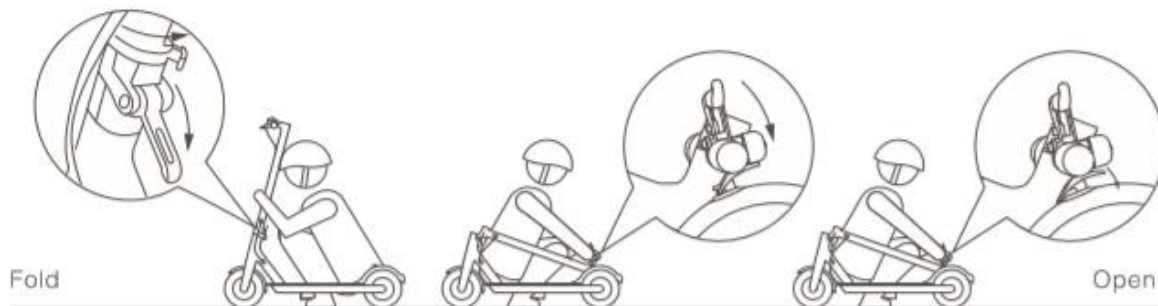

CARRYING

You can use the control rod for carrying.



CHARGING

Do not use batteries or chargers other than those supplied by the original supplier.

Charge the scooter at room temperature.

1. Remove the rubber cap
2. Connect the charger
3. After recharging, attach the rubber cap again

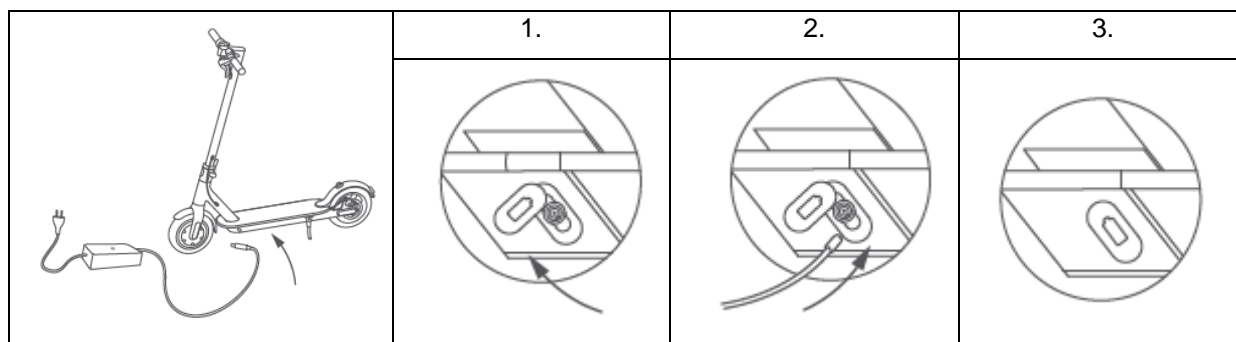

BATTERY

6-month battery warranty – we guarantee that battery's nominal capacity does not fall below 70% of its total capacity within 6 months of the product's sale.

Do not open the battery. Contacting the battery with metal objects can cause the battery to short circuit.

Always use only the original charger.

Please recharge the battery after each use.

Do not expose the battery to temperatures below -20 ° C and above 50 ° C.

Do not dispose of the battery in a fire.

For longer storage than 30 days, fully charge the battery, then recharge every 60 days.

HOW TO RIDE

- Get to know the product before your first ride and learn how to operate it properly.
- Always turn slowly and always brake safely and with sufficient braking space.
- For the first ride, choose a free environment without obstacles.
- Fully concentrate on riding and do not let anything distract.
- Use the accelerator only if you have both feet on the scooter board.

Leg Position: Place one leg on the plate as close as possible to the front of the scooter. Leave the other leg on the ground. Make sure the track is clear and clean. Start the ride with a slight bend (just like a classic scooter). Push with that foot that rests on the ground. As soon as you press the accelerator, try to lean back slightly to prevent falling due to acceleration. When changing speed, try not to press too much on the handlebar bar. One leg is more in the front and the other in the back. You can place your feet just like a skateboard for a more comfortable ride and better stability.

NOTE: Riding a scooter can be dangerous. You use this product on your own responsibility. Be fully familiar with all regulations and restrictions.

MAINTENANCE

BRAKES

If the brakes are too stiff, you can use the M5 Allen key to release the brake cable at the brake pads.

If the brakes are too light, you can use the M5 Allen wrench to apply the brake cable to the brake pads.

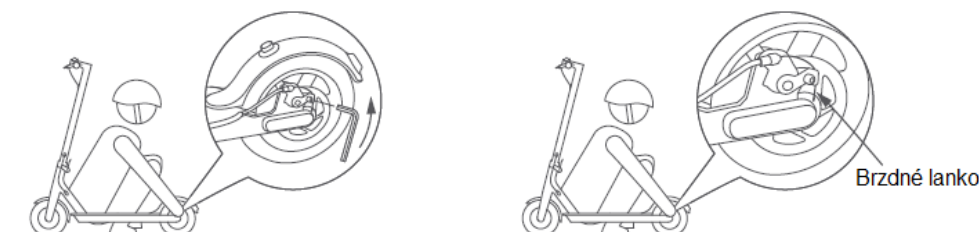

CONTROL BAR

Tighten the screws on the folding mechanism with the Allen key.

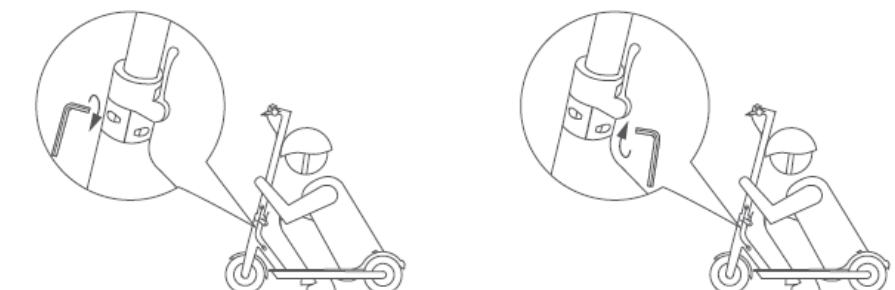

TIRES

If the tubes are deflated, it must be re-inflated. Remove the valve and inflate to the required hardness. Then replace the valve.

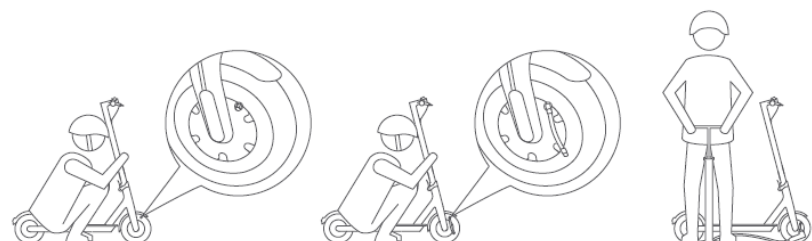

CLEANING

After each use, clean the dirt with a damp cloth. In the case of more resistant dirt, you can use soap and then wipe off the rest of the dirt with a cloth.

WARNING: Do not use alcohol, benzene or other aggressive chemical cleaners. Do not use high-pressure cleaners. When cleaning, it is necessary to unplug the scooter and secure the charging port with a rubber cap. Do not immerse the scooter in water. Contacting a battery or other electronic scooter may result in short circuit or damage.

STORAGE

Store the scooter in a dry and shady place. Exposure to direct sunlight, overheating or freezing can damage the scooter and battery.

For longer storage than 30 days, fully charge the battery, then recharge every 60 days.

Do not expose the scooter to temperatures below -20 ° C and above 50 ° C.

TECHNICAL PARAMETERS

Dimensions	Length x width x height - unfolded state	1080 x 430 x 1140 mm
	Length x width x height - folded state	1080 x 430 x 490 mm
Weight	Weight	12.5 kg
Requirements	Load capacity	100 kg
	Age	16–50 years
	Height	120–200 cm
Parameters	Maximal speed	20 km/h
	Maximum range	18-25 km
	Tilt	15°
	Suitable terrain	Straight terrain, without bumps, obstacles lower than 1 cm and narrower than 3 cm
	Operating temperature	-10–40 °C
	Storage temperature	-20–50 °C
	Protection	IP54
Battery	Tension	36 V
	Maximum voltage	42 V
	Capacity	280 Wh
	Function	Protection against short circuit, undercuts, overcharging
Motor	Tension	250 W
	Maximum voltage	500 W
Charger	Tension	70 W
	Input voltage	110–210 V
	Output voltage	42 V
	Current	1.7 V
	Charging time	approx. 3 hours

Maximum speed and riding distance data are depended on external conditions such as user weight, ambient temperature, etc.

ENVIRONMENT PROTECTION

After the product lifespan expired or if the possible repairing is uneconomic, dispose it according to the local laws and environmentally friendly in the nearest scrapyard.

By proper disposal you will protect the environment and natural sources. Moreover, you can help protect human health. If you are not sure in correct disposing, ask local authorities to avoid law violation or sanctions.

Don't put the batteries among house waste but hand them in to the recycling place.

TERMS AND CONDITIONS OF WARRANTY, WARRANTY CLAIMS

General Conditions of Warranty and Definition of Terms

All Warranty Conditions stated here under determine Warranty Coverage and Warranty Claim Procedure. Conditions of Warranty and Warranty Claims are governed by Act No. 89/2012 Coll. Civil Code, and Act No. 634/1992 Coll., Consumer Protection, as amended, also in cases that are not specified by these Warranty rules.

The seller is SEVEN SPORT s.r.o. with its registered office in Strakonická street 1151/2c, Prague 150 00, Company Registration Number: 26847264, registered in the Trade Register at Regional Court in Prague, Section C, Insert No. 116888.

According to valid legal regulations it depends whether the Buyer is the End Customer or not.

"The Buyer who is the End Customer" or simply the "End Customer" is the legal entity that does not conclude and execute the Contract in order to run or promote his own trade or business activities.

"The Buyer who is not the End Customer" is a Businessman that buys Goods or uses services for the purpose of using the Goods or services for his own business activities. The Buyer conforms to the General Purchase Agreement and business conditions.

These Conditions of Warranty and Warranty Claims are an integral part of every Purchase Agreement made between the Seller and the Buyer. All Warranty Conditions are valid and binding, unless otherwise specified in the Purchase Agreement, in the Amendment to this Contract or in another written agreement.

Warranty Conditions

Warranty Period

The Seller provides the Buyer a 24 months Warranty for Goods Quality, unless otherwise specified in the Certificate of Warranty, Invoice, Bill of Delivery or other documents related to the Goods. The legal warranty period provided to the Consumer is not affected.

By the Warranty for Goods Quality, the Seller guarantees that the delivered Goods shall be, for a certain period of time, suitable for regular or contracted use, and that the Goods shall maintain its regular or contracted features.

The Warranty does not cover defects resulting from (if applicable):

- User's fault, i.e. product damage caused by unqualified repair work, improper assembly, insufficient insertion of seat post into frame, insufficient tightening of pedals and cranks
- Improper maintenance
- Mechanical damages
- Regular use (e.g. wearing out of rubber and plastic parts, moving mechanisms, joints, wear of brake pads/blocks, chain, tires, cassette/multi wheel etc.)
- Unavoidable event, natural disaster
- Adjustments made by unqualified person
- Improper maintenance, improper placement, damages caused by low or high temperature, water, inappropriate pressure, shocks, intentional changes in design or construction etc.

Warranty Claim Procedure

The Buyer is obliged to check the Goods delivered by the Seller immediately after taking the responsibility for the Goods and its damages, i.e. immediately after its delivery. The Buyer must check the Goods so that he discovers all the defects that can be discovered by such check.

When making a Warranty Claim the Buyer is obliged, on request of the Seller, to prove the purchase and validity of the claim by the Invoice or Bill of Delivery that includes the product's serial number, or eventually by the documents without the serial number. If the Buyer does not prove the validity of the Warranty Claim by these documents, the Seller has the right to reject the Warranty Claim.

If the Buyer gives notice of a defect that is not covered by the Warranty (e.g. in the case that the Warranty Conditions were not fulfilled or in the case of reporting the defect by mistake etc.), the Seller is eligible to require a compensation for all the costs arising from the repair. The cost shall be calculated according to the valid price list of services and transport costs.

If the Seller finds out (by testing) that the product is not damaged, the Warranty Claim is not accepted. The Seller reserves the right to claim a compensation for costs arising from the false Warranty Claim.

In case the Buyer makes a claim about the Goods that is legally covered by the Warranty provided by the Seller, the Seller shall fix the reported defects by means of repair or by the exchange of the damaged part or product for a new one. Based on the agreement of the Buyer, the Seller has the right to exchange the defected Goods for a fully compatible Goods of the same or better technical characteristics. The Seller is entitled to choose the form of the Warranty Claim Procedures described in this paragraph.

The Seller shall settle the Warranty Claim within 30 days after the delivery of the defective Goods, unless a longer period has been agreed upon. The day when the repaired or exchanged Goods is handed over to the Buyer is considered to be the day of the Warranty Claim settlement. When the Seller is not able to settle the Warranty Claim within the agreed period due to the specific nature of the Goods defect, he and the Buyer shall make an agreement about an alternative solution. In case such agreement is not made, the Seller is obliged to provide the Buyer with a financial compensation in the form of a refund.

CZ

SEVEN SPORT s.r.o.

Registered Office: Strakonická 1151/2c, Praha 5, 150 00, ČR
Headquarters: Dělnická 957, Vítkov, 749 01
Warranty & Service: Čermenská 486, Vítkov 749 01

CRN: 26847264
VAT ID: CZ26847264

Phone: +420 556 300 970
E-mail: eshop@insportline.cz
reklamace@insportline.cz
servis@insportline.cz

Web: www.inSPORTline.cz

SK

inSPORTline s.r.o.

Headquarters, warranty & service center: Električná 6471, Trenčín 911 01, SK

CRN: 36311723
VAT ID: SK2020177082

Phone: +421(0)326 526 701
E-mail: objednavky@insportline.sk
reklamacie@insportline.sk
servis@insportline.sk

Web: www.inSPORTline.sk