



USER MANUAL – EN
IN 12569 Windrunner Handy U2



CONTENTS

- DOCUMENT OVERVIEW 3
 - Document overview 3
 - Relevant User Manual 3
 - Relevant Explanation of Document 3
- PRODUCT INTRODUCTION 3
 - U2 Model Information..... 3
 - How U2 Works 4
- U2 INSTALLATION 4
 - Check if All Parts in U2 Packing Box Are Complete 4
 - Install U2 4
- U2 SENSOR AND INFORMATION DISPLAY DEVICE 6
 - Foot Sensor..... 6
 - Display 6
- BATTERY INSTRUCTIONS 6
 - Battery Capacity..... 6
 - Charging Procedures 6
 - Over-Temperatures and Low-Temperature Conditions 7
 - Detailed Battery Specifications 7
 - Notes Needing Attention When Transporting the Battery..... 7
- SAFE USE OF U2 7
 - Weight Limit of the Driver..... 8
 - Maximum Driving Distance 8
 - Speed Limit 8
 - Alarm and Warn 8
- LEARN HOW TO DRIVE U2 9
 - Safe Stopping 9
 - Driving Procedures 9
 - Driving Practice 10
- DRIVING SAFETY GUIDANCE..... 10
- MAINTENANCE 11
 - U2 Transportation 12
 - Cleaning 12
 - Storage..... 12
- U2 PARAMETRES 12
- FAULT HANDLING..... 13
- TERMS AND CONDITIONS OF WARRANTY, WARRANTY CLAIMS..... 14

DOCUMENT OVERVIEW

Document overview

Describe safety and warning information in order to ensure that every driver can drive U2 safely and enjoy the pleasure it brings.

Introduce each part of U2.

Discuss about the procedures to assemble U2.

Describe matters needing attention about driving safety.



Provide detailed driving methods and skills.

Relevant User Manual

User Manual aims at helping you to assemble and use U2 correctly and providing more detailed and comprehensive information. In order to avoid injuries, please drive U2 according to the guidance of the User Manual.

Relevant Explanation of Document

The following explanations are applicable to the whole User Manual

 WARNING!	Warning: Your misconduct may bring threat to physical security of people around you.
 CAUTION	Caution: Your misconduct may cause issues or damage of TT.
 NOTE:	Note: Matters needing attention from the user and relevant usage.

PRODUCT INTRODUCTION

U2 Model Information

TT is a kind of high-tech self-balancing electric scooter that adopts dynamic balancing principle to control forward, backward and stop; When U2 is in the mode of balance, you can control the running speed and heading direction to let it head towards your destination at your will.

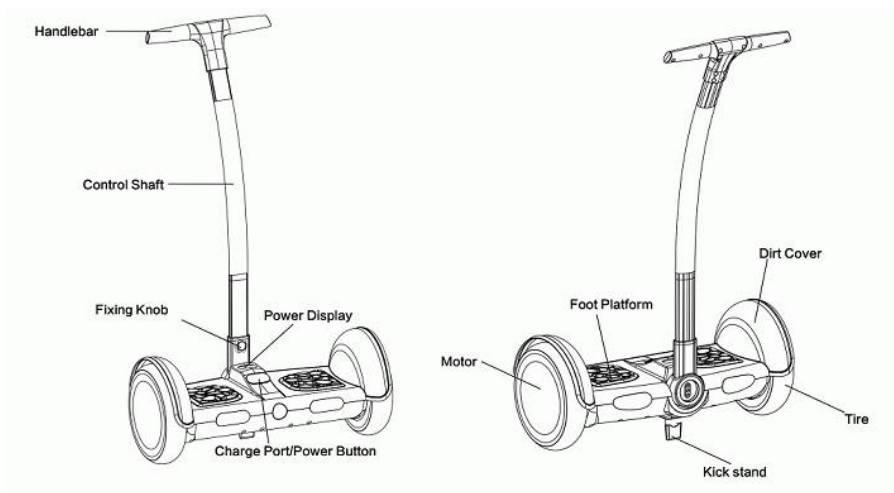

How U2 Works

TT Includes body, motor and electrical system. The motor is installed at the two sides of body, and power supply, control circuit, driving system, sensor and control switch are installed inside the body, between the wheel and body is rotation, speed sensor and angle sensor they will transmit turn angle and dip angle information to the control center in order to balance U2's gravity center (combination of human and TT). U2 is just like human body, when your body bends forward, you will have to move a step forward to keep balance. When you stand on U2 and bend forward or backward, the power unit will control the wheel to move forward or backward to keep balance. The handlebar will control steering function, when you move the handlebar leftward, U2 will steer leftward; and when you move the handlebar rightward, U2 will steer rightward. When the handlebar is in the middle, U2 will stay in its direction. The built-in inertia dynamic stability system will keep the level of forward and backward directions, yet it can't guarantee their stability. Hence, when the driver operates the U2 steering, the driver's body shall lean with the steering lever in order to control the steering centrifugal force and enhance the safety steering.

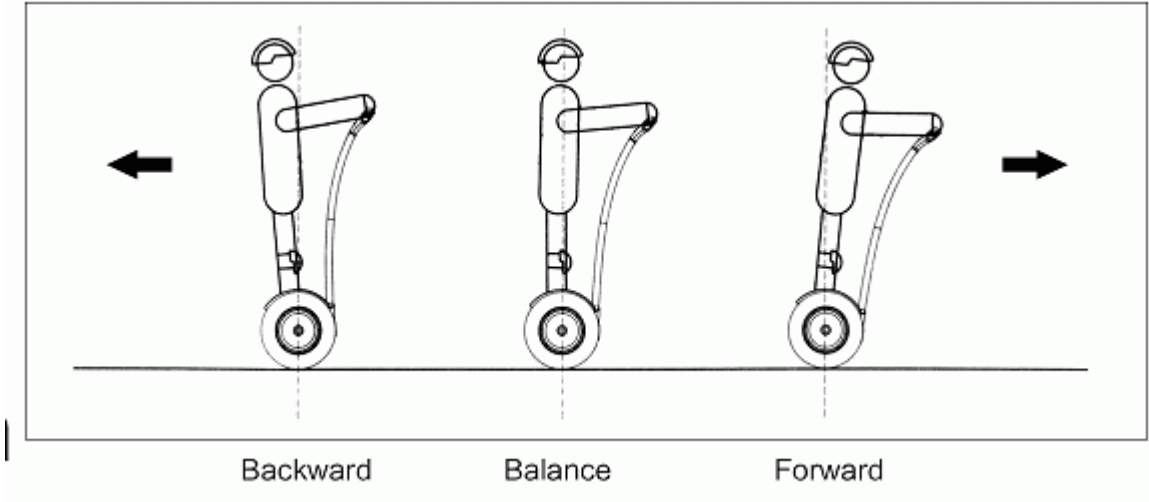

U2 INSTALLATION

The content of this part is to check components that U2 contains and installation guidance.

Check if All Parts in U2 Packing Box Are Complete

1. Body	4. Charger
2. Control shaft	5. Toolkit
3. Handlebar of control shaft	6. User Manual and Warranty Card

Install U2

Step 1: Install the control shaft with the handlebar according to the direction shown in the figure (Mind forward and backward directions).

Step 2: Insert components of the control shaft into the body as the direction is shown in the figure (Mind forward and backward directions of the control shaft).

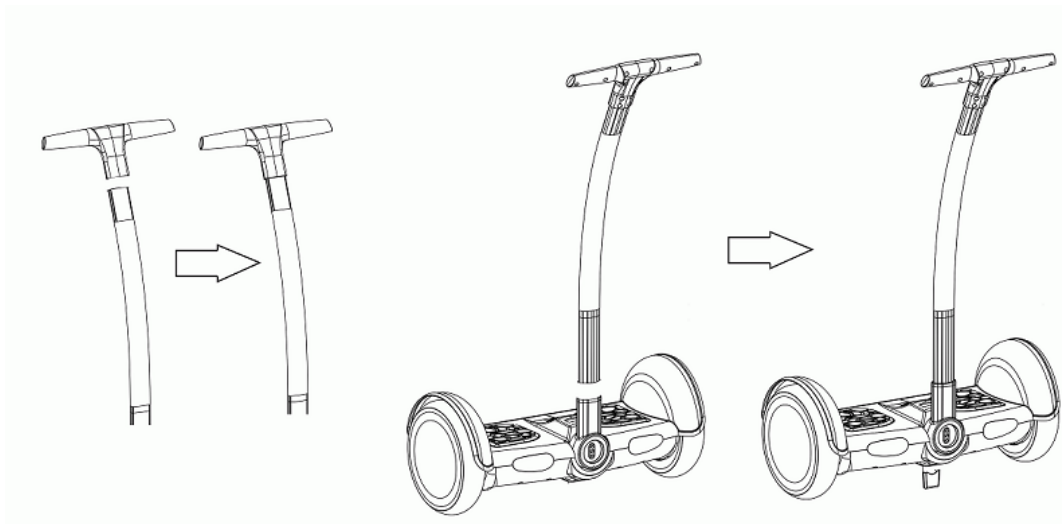

Step 3: Install fixing knob of the control shaft

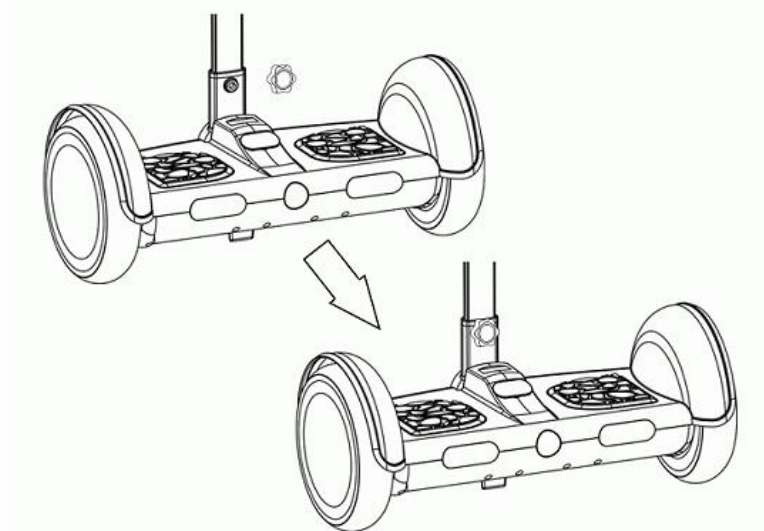

Step 4: Turn on U2 main switch, initiate function



WARNING! Before any operations of maintenance and component installation, make sure that U2 is disconnected from charger.

U2 SENSOR AND INFORMATION DISPLAY DEVICE

Foot Sensor

There are four sensors under foot platform, stepping on foot platform when U2 is flat on the floor, and U2 will automatically adjust into balance mode.

WARNING! When driving U2, you must make sure that foot platform is in foot resting status. Please don't step beyond the area of foot platform. Please, don't put things carried on foot platform which will make U2 start and increase the rate of U2 collision and thus causing personal injury or U2 damage.

Display

The display is located between the U2 two foot platforms for displaying U2.

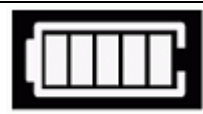

Display: It can display U2 power. Please charge timely when the power display is less than one bar (20%).

BATTERY INSTRUCTIONS

Mainly about U2 charging method, how to maintain the battery, safety matters and explanation of battery specification.

Warning: In order to extend the life of the battery, guarantee safety of you and others and improve the battery's performance, please use the battery according to the following operations.

Battery Capacity

You must stop driving when the battery power is low as U2 will not have enough capacity for you to drive normally. At the moment, the system will reduce speed automatically. U2 shut down automatically when the speed is reduced, then it can't be started. If you keep driving U2 at the moment, you will probably fall over yourself and cause injury, and in the meantime the life of the battery will be influenced.

Warning: Do not use the battery when the following cases happen: If some peculiar smell send out or heat over 2 leak out of any material. Only limited professional personnel to carry out the demolition and maintenance of the battery.

Don't touch any material that the battery leaks out.

Don't let kids and animals touch the batteries. Be sure to pull out the charger before installing the battery or driving. In the charging case to do anything about U2 is dangerous.

Battery contains hazardous substances, do not open the battery, do not add anything to the battery.

Can only use the equipment provided by the factory to U2 charging.

U2 battery should be used under the local law.

Charging Procedures

Open the U2 charging port which should be confirmed to be dry.

Plug one end of the charge cable onto U2 and plug the charger into the power supply.

When the indicator light turns red, it is charging normally. If not, please check if the circuit is well connected.

When the indicator light turns green, the charging is completed. Please stop charging now. Over-time charging will influence the life of the battery. The charging shall be done only when U2 is shut down. In the middle of charging, please, don't start up U2 or the battery will be damaged.

NOTE: Pay attention to using the local standard plug.

According to the provisions to charge or storage battery, otherwise the battery will be damaged and its service life will be shorter.

Affecting the battery life. U2's charging time is about 1.5 hours, and the long charging time will affect the battery life

WARNING! The charging environment should be clean and dry. Do not charge when charging port is wet.

Over-Temperatures and Low-Temperature Conditions

To get most highly efficient of U2 operation, the temperature of the battery shall be within the scope of temperature marked in battery specifications. If the temperature is too high or too low in the process of U2 driving, the system will trigger safety alarm. The temperature of U2 before and in the process of charging shall be within the scope of the recommended value. When the temperature approaches the recommended value, the efficiency of charging will be the best. But when the temperature is too high or too low, the charging time will be lengthened or the battery can't be fully charged.

Detailed Battery Specifications

Battery Type	Lithium Battery
Charging Time	1.5 ~ 2 Hours
Voltage	36V
Battery Weight	1KG
Initial Capacity	4.4Ah ~ 8.8Ah (Optional)
Working Temperature	-15 ~ 50°C
Charging Temperature	-15 ~ 50°C
Relevant Humidity of Storage	5% ~ 50%

Notes Needing Attention When Transporting the Battery

WARNING! Lithium Battery is considered as a hazardous substance, so its transportation shall get lawful permission.

NOTE: If you need to make an air shipment of U2 loaded with a lithium battery or adopt any other means of transportation to separately transport U2's lithium battery, please contact our company or agent designated by our company.

SAFE USE OF U2

Our company hopes that all drivers can drive U2 safely and enjoy infinite pleasure. You can recall how you learn to ride a bike, drive a car, ski or use other similar vehicles, all these experiences can be applied to our product. By conforming to the contents in User Manual, you can drive U2 safely. We highly recommend that you should carefully read through User Manual when you drive U2 for the first time. Before driving U2 each time, please check if U2 tire is damager or some parts are loosing. If there is any abnormal condition, please contact our agent to maintain it ASAP. Never drive U2 in the rainy days, it's very dangerous.

WARNING! Please read the User Manual carefully and will get a lot of important safety information including speed limit, vibration warning, safe shutdown and other issues.

Correctly install individual components before using U2 to prevent damage to the U2.

Please do not use U2 to make anything harming the personal or property safety.

Please do not arbitrarily modify the part of the U2, this will affect its performance and damage it, and maybe it will cause a serious damage.

Weight Limit of the Driver

The reason for limiting the weight of driver are as following:

Guarantee the driver's safety.

Reduce the damage to U2 cause by overload.

Maximum weight limit of the driver: 80KG

Minimum weight limit of the driver: 25KG

WARNING! Overweight will make you be in danger of falling over.

Maximum Driving Distance

Maximum operating range of U2 is influenced by many factors, such as:

Ground type: the driving distance will be increased when it is driven on smooth and flat ground. On the contrary, the driving distance will be reduced.

Speed and driving style: keeping medium speed will increase driving distance. Frequent stopping, accelerating and decelerating will reduce driving distance.

Weight of the driver will influence the driving distance. Store and drive U2 under recommended temperature value, the driving distance will be increased.

On the contrary, the driving distance will be reduced.

Speed Limit

When the driver drives U2 at a speed approaching the maximum permission speed, U2 handlebar will actively lean to the driver, which is reminding the driver to stop accelerating; When the driver drives backward at a speed approaching the limit speed for driving backward, the buzzer will sound an alarm which reminds the driver to decelerate or to drive forward.

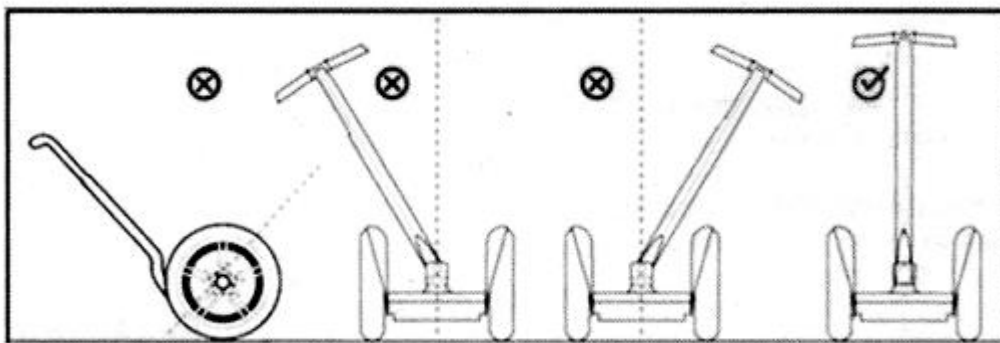

NOTE: Please, do not drive or steering on the slope, which will cause misregistration of balance angle of U2 and influence the driving safety.

Alarm and Warn

U2 will give an alarm and warn the driver under the following situation: (1) over-speed driving forward (2) over-speed driving backward (3) User tries to get on U2 in charging mode. Please stop incorrect usage immediately under situation (2) and (3). If violent vibration occurs in the process of driving, please get off U2 immediately. Please don't continue driving in the process of vibration.

WARNING! When the driver gets off U2, it will keep balance for one second.

LEARN HOW TO DRIVE U2

You need to pay attention to relevant safety matters when using U2. Hence, you must get a full understanding of all matters needing attention mentioned in User Manual before using the product. It is very important for you to understand these safety matters before the usage.

Safe Stopping

Moving the center of your gravity towards the opposite direction of the movement direction can stop U2, the methods are as following:

1. When you move forward, please pull back your bottom slowly (imagine that you're are just going to sit down backward) to stop U2.
2. When U2 comes to full stop, averagely distribute your weight in the middle of the foot platform to realize stability. At the moment, if you continue leaning backward, U2 will move backward.
3. Designate an open place and practice driving U2 at the place and remain stable.

WARNING! When the battery capacity exhausted or the system generates safety stopping information, don't continue driving U2, or U2 can't make a balance because of low power and the driver will probably be injured. When the battery capacity reaches the lowest limit, the life of battery will be influenced if you continue driving U2.

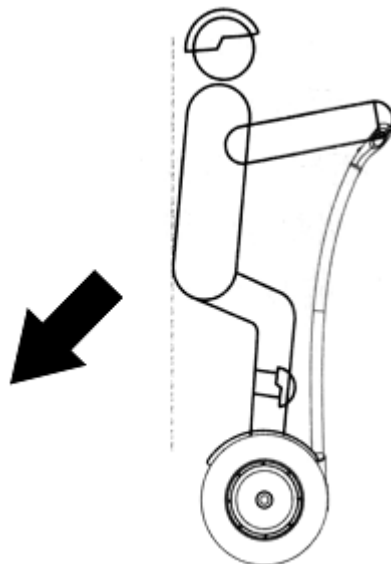

Standard Brake Manner

Driving Procedures

Step 1: Start U2

Press the power button

Step 2: Driving Preparations

Keep U2 flat, set a single foot on the foot platform, U2 will automatically balance rapidly, it means that U2 has started, then set another foot on it.

Step 3: Control U2 actions

When stand on U2 successfully, please keep a balance of your center of gravity and keep U2's static status. Control forward and backward of U2 by small range of forward leaning or backward leaning of your body. Keeping in mind that movement range of your body shall not be too large.

Step 4: Control left and right directions of U2

Swing U2 handlebar leftward, U2 will turn left. Swing U2 handlebar rightward, U2 will turn right.

Step 5: Get off TT

Make U2 static before getting off U2, keep the balanced state, get one foot off it first and another one shall leave the foot platform rapidly. The static status keeps half an hour and U2 will automatically turn off.

WARNING! Please don't violently shake the handlebar, or the occurrence rate of accidents will be increased. When getting off it, please keep the balance of U2.

Driving Practice

When you want to drive U2 outdoors, please make sure that you can drive U2 skillfully for the consideration of your safety.

When driving U2 for the first time, please practice in safe and spacious field.

Please repeatedly practice how to drive U2 in an open field until you can easily get on U2.

You can drive it on narrow and crooked road through practices.

If you can't drive U2 proficiently, please avoid driving it in the place where there are children, pedestrians, vehicles or roadblocks.

Mind if the ground is smooth.

You can learn to drive on different landforms. Don't separate U2 from the ground at any time.

When the user drives on different roadbeds, make sure that the handlebar is in vertical state. Steer the handlebar and make it move towards the direction as you wish. Allow the tire moves according to road contours.

Please slow down when driving on complicated roads.

DRIVING SAFETY GUIDANCE

This section provides some safety knowledge and warning statements and make you have relevant understanding of safety notes before using U2. To ensure that you can drive U2 safely, please read through User Manual and confirm to relevant safety tips. Please note all safety warnings and usage notes mentioned in User Manual, a better understanding of these notes will enhance the safety for you to drive U2.

WARNING! You may be injured because of losing control, colliding and falling over at any time you use U2. In order to avoid injuries, you must carefully read and refer to instructions in User Manual and then drive U2.

Please make sure that U2 service condition is good and use it after reading over and being familiar with all materials of your company.

When driving U2, please make sure that you have made good safety precautions, like wearing a helmet, kneecap and so on.

U2 is only suitable for a single person. Forbid multiple people use one U2 simultaneously. Forbid using this product on motorways.

Install every part well before using U2 to avoid damaging U2 or injuries caused by losing control, colliding and falling over.

Please wear safety gears and helmet when driving U2.

Please don't let child, old man the aged and pregnant women drive U2.

Please don't drive it after drinking wine or taking medicine.

Please don't drive it with carrying objects. Please comply with local traffic regulations when driving U2.

Please look out for objects in front of you or remote from you.

Keeping a good vision will help you to drive U2 safely.

Hold the handlebar, relax legs, slightly bend your knees, by which you can keep balance when driving on uneven ground.

Hold the handlebar tightly and make sure that your soles stay on the foot platform.

Keep a certain distance between your body and handlebar.

If they stay too close, the probability of collision, falling over and losing control will be increased.

Please wear sport clothes when driving U2 to help you to deal with emergencies.

The weight of the user and all objects shall not be over the maximum load marked in the instruction, or the driver will easily fall over or get injured, and even the function of U2 will be damaged.

Besides, the weight of the driver should not be less than the minimum value of user's weight, or the driver can't control U2, especially when driving downhill, the driver can't safely reduce speed or stop.

Make sure that the speed can guarantee the safety of yourself and others. Prepare for stopping at any time.

Comply with traffic regulations, politely give way to others.

If it occurs a traffic accident when you drive U2, please wait on site for personnel from relevant department and deal with it reasonably.

When you drive U2 with another person who is also driving another U2, please keep a certain distance between you to avoid collision.

Always remember that the height of the place where your body is at have been increased for about 10cm when driving U2.

Mind your head when passing a gate.

Mind the balance of center of your gravity when doing steering operations. Avoid falling down from U2 because of center-of-gravity shift or over speed.

Divert your attention when driving U2 such as answering a call, listening to music or other activities.

When the battery is exhausted or reaches minimum safety electricity, the system will automatically shut down.

Please don't start U2 again, or U2 will fall over because it doesn't have enough electricity to maintain a balance.

When U2 is in the mode of balance, please don't loose your hands, or U2 will automatically move forward for a certain distance, which may harm others or damage U2.

Don't let a child drive it. It is recommended only a person who is more than 14 years old can drive U2.

This vehicle hasn't become a medical device by means of design, test or other verification. The user must use it without outside help. Don't drive U2 in a dark place.

Avoid driving it on the ground where there are obstacles or on a slippery ground, like: snowfield, ice ore slippery floor.

Please don't drive it in a narrow place or a place with a big obstacle.

Please use it in the environment conforming to U2 service conditions.

When driving it in the environment needing permission of others, please get their permission first.

Please don't start or stop suddenly.

Avoid driving it on a steep slope.

Forbid using U2 in unsafe environment. Unsafe environment refers to sites where fire or explosion may happen because of inflammable gas, steam, liquid, dust or fiber and other reasons.

MAINTENANCE

U2 need a daily maintenance from the user. The following is about relevant maintenance procedures and important operating tips.

WARNING! Before conducting the following operations, please ensure that U2 power supply is disconnected from charging cable. Operations shall not be made when the power is on or the battery is being charged.

U2 Transportation

Lift and put down U2 with reasonable skills. The following procedures shall be followed when transporting U2:

Ensure that U2 isn't connected to the charger and U2 is in shutdown mode.

Use one hand to hold the tail of control shaft, lift U2, and use another hand to assist in transportation; Don't use plastic shell as a force bearing point to transport it.

Use your arm to transport U2 to the location as you wish.

9.2. Maintenance of Wheels

Checking the wheels regularly. Shake it along the direction which the tire rotates towards, observe if tire assemblies also shake; If they do, please contact after-sale personnel to solve this matter.

Regularly check if left and right tires are seriously worn and if the wears of left and right tires are uniform.

If the tires are worn seriously, please contact after-sale personnel to order for new ones.

Cleaning

Notes before cleaning:

Ensure that U2 power supply is disconnected with charging cable.

Use a soft cloth to wipe and clean U2.

WARNING! Avoid using water or other liquid to clean U2. If water or other liquid penetrate into U2, internal parts of U2 will be permanently damaged.

Storage

Please store U2 indoors and in dry place with suitable temperature. Don't connect the power supply, if U2 will not be used for a long time.

WARNING! The user shouldn't open upper cover plate and internal control circuit plate. There are no parts that user can maintain by himself; The user shouldn't open the motor, there are no parts that user can maintain. The user shouldn't disassemble U2, or it means that the user himself gives up the right of product maintenance.

U2 PARAMETRES

Product	U2 8 Inches	Remarks
N.W	13.5KG	
Minimum Load	25KG	
Maximum Load	80KG	
Maximum Speed/h	12KM/h	
Maximum Range	10-20KM	
Turning Radius	0M	
Energy	Chargeable Lithium Battery	
Charging Requirements	220V-240V 50 or 60 Hz	
Length, Width	57* 31cm	

Height of Complete Machine	98cm	
Ground Clearance	5cm	From the ground
Tire Type	Solid tire	
Battery	4.4Ah-8.8Ah	Optional
Tire Size	8 Inches	
Motor	250W x2	36V

Product	U2 10 Inches	Remarks
N.W	15KG	
Minimum Load	25KG	
Maximum Load	80KG	
Maximum Speed/h	12KM/h	
Maximum Range	10-20KM	
Turning Radius	0M	
Energy	Chargeable Lithium Battery	
Charging Requirements	220V-240V 50 or 60 Hz	
Length, Width	64* 31cm	
Height of Complete Machine	102cm	
Ground Clearance	6.5cm	From the ground
Tire Type	Pneumatic tire	
Battery	4.4Ah-8.8Ah	Optional
Tire Size	10 Inches	
Motor	250W x2	36V

FAULT HANDLING

U2 self-check items: sensor, system static current, dynamic current, motor speed fluctuations, etc.

When you check out the fault and you cannot solve, please contact to the company service network for maintenance.

U2 Warranty Card

Model:	
Name:	Tel.:
Add:	Date:

Warranty Instructions

- U2 user should keep this warranty card as maintenance certificate
- The warranty period of control board, motors and battery are six months.
- One month for wearing parts, i.e. casings and tires.

The following situations will not be covered by the warranty:

- Malfunction due to misuse

- Malfunction caused by unauthorized modifications, disassembling, or repair.
- Damage or malfunction caused by riding on rainy days or dipping water.

Product Qualification Certificate

Name:	Model:
Inspector:	Date:

This product is qualified and approved for delivery.

TERMS AND CONDITIONS OF WARRANTY, WARRANTY CLAIMS

General Conditions of Warranty and Definition of Terms

All Warranty Conditions stated hereunder determine Warranty Coverage and Warranty Claim Procedure. Conditions of Warranty and Warranty Claims are governed by Act No. 40/1964 Coll. Civil Code, Act No. 513/1991 Coll., Commercial Code, and Act No. 634/1992 Coll., Consumer Protection Act, as amended, also in cases that are not specified by these Warranty rules.

The seller is SEVEN SPORT s.r.o. with its registered office in Borivojova Street 35/878, Prague 13000, Company Registration Number: 26847264, registered in the Trade Register at Regional Court in Prague, Section C, Insert No. 116888.

According to valid legal regulations it depends whether the Buyer is the End Customer or not.

“The Buyer who is the End Customer” or simply the “End Customer” is the legal entity that does not conclude and execute the Contract in order to run or promote his own trade or business activities.

“The Buyer who is not the End Customer” is a Businessman that buys Goods or uses services for the purpose of using the Goods or services for his own business activities. The Buyer conforms to the General Purchase Agreement and business conditions to the extent specified in the Commercial Code.

These Conditions of Warranty and Warranty Claims are an integral part of every Purchase Agreement made between the Seller and the Buyer. All Warranty Conditions are valid and binding, unless otherwise specified in the Purchase Agreement, in the Amendment to this Contract or in another written agreement.

Warranty Conditions

Warranty Period

The Seller provides the Buyer a 24 months Warranty for Goods Quality, unless otherwise specified in the Certificate of Warranty, Invoice, Bill of Delivery or other documents related to the Goods. The legal warranty period provided to the Consumer is not affected.

By the Warranty for Goods Quality, the Seller guarantees that the delivered Goods shall be, for a certain period of time, suitable for regular or contracted use, and that the Goods shall maintain its regular or contracted features.

The Warranty does not cover defects resulting from:

- User’s fault, i.e. product damage caused by unqualified repair work and improper assembly
- Improper maintenance
- Mechanical damages
- Regular use (e.g. wearing out of rubber and plastic parts, joints etc.)
- Unavoidable event, natural disaster
- Adjustments made by unqualified person
- Improper maintenance, improper placement, damages caused by low or high temperature, water, inappropriate pressure, shocks, intentional changes in design or construction etc.

Warranty Claim Procedure

The Buyer is obliged to check the Goods delivered by the Seller immediately after taking the responsibility for the Goods and its damages, i.e. immediately after its delivery. The Buyer must check the Goods so that he discovers all the defects that can be discovered by such check.

When making a Warranty Claim the Buyer is obliged, on request of the Seller, to prove the purchase and validity of the claim by the Invoice or Bill of Delivery that includes the product's serial number, or eventually by the documents without the serial number. If the Buyer does not prove the validity of the Warranty Claim by these documents, the Seller has the right to reject the Warranty Claim.

If the Buyer gives notice of a defect that is not covered by the Warranty (e.g. in the case that the Warranty Conditions were not fulfilled or in the case of reporting the defect by mistake etc.), the Seller is eligible to require a compensation for all the costs arising from the repair. The cost shall be calculated according to the valid price list of services and transport costs.

If the Seller finds out (by testing) that the product is not damaged, the Warranty Claim is not accepted. The Seller reserves the right to claim a compensation for costs arising from the false Warranty Claim.

In case the Buyer makes a claim about the Goods that is legally covered by the Warranty provided by the Seller, the Seller shall fix the reported defects by means of repair or by the exchange of the damaged part or product for a new one. Based on the agreement of the Buyer, the Seller has the right to exchange the defected Goods for a fully compatible Goods of the same or better technical characteristics. The Seller is entitled to choose the form of the Warranty Claim Procedures described in this paragraph.

The Seller shall settle the Warranty Claim within 30 days after the delivery of the defective Goods, unless a longer period has been agreed upon. The day when the repaired or exchanged Goods is handed over to the Buyer is considered to be the day of the Warranty Claim settlement. When the Seller is not able to settle the Warranty Claim within the agreed period due to the specific nature of the Goods defect, he and the Buyer shall make an agreement about an alternative solution. In case such agreement is not made, the Seller is obliged to provide the Buyer with a financial compensation in the form of a refund.



SEVEN SPORT s.r.o.

Registered Office:	Borivojova 35/878, 130 00 Praha 3, Czech Republic
Headquarters:	Delnicka 957, 749 01 Vitkov, Czech Republic
Warranty & Service Centre:	Cermenska 486, 749 01 Vitkov, Czech Republic
CRN:	26847264
VAT ID:	CZ26847264
Phone:	+420 556 300 970
E-mail:	eshop@insportline.cz reklamace@insportline.cz servis@insportline.cz
Web:	www.insportline.cz

SK

INSPORTLIN s.r.o.

Headquarters, Warranty & Service centre:	Elektricka 6471, 911 01 Trenčin, Slovakia
CRN:	36311723
VAT ID:	SK2020177082
Phone:	+421(0)326 526 701
E-mail:	objednavky@insportline.sk reklamacie@insportline.sk servis@insportline.sk

Web: www.insportline.sk

Date of Sale:

Stamp and Signature of Seller: